

Series 541 Residential Sliding Door



Photo courtesy of Hanlon Windows



Series 541 Residential Sliding Door

DATE: NOV 09
 REPLACES: AUG 03
 SCALE: NOT TO SCALE

KEY FEATURES / PERFORMANCE CHARACTERISTICS

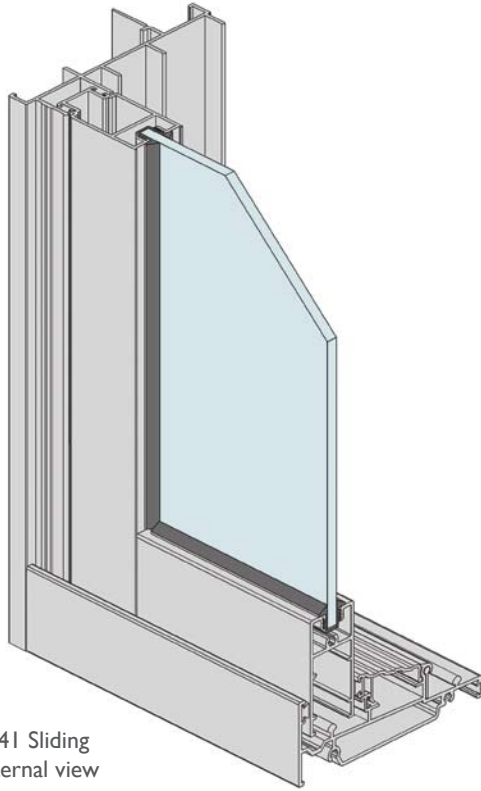

Series 541 Sliding door internal view

- Successfully tested for compliance with AS 2047.
- 102mm frame with 26mm thick stiles.
- Optional meeting stile strengths cover a large variety of design wind load areas.
- The meeting stiles have been designed to withstand high wind loads, and equally important the lock stile has enough body strength to carry the lock and not flex excessively while opening and closing the door.
- Two heavy duty sill options - One for standard water performance and a slightly taller sump type sill for high water performance.
- Low line nursing home sill option also available, shown later in these notes.
- Flydoors slide on the outside and run on large diameter wheels.
- Glass door external meeting stile has built-in interlock to accept the flydoor interlock.
- Panels can be re-handed on site (slide direction reversed).
- Door panels can be glazed with thick or insulating glass units.
- Optional tall bottom rail available.

Maximum Panel Height*	2350mm
Maximum Panel Width*	1200mm
Maximum Glass Thickness	≤ 20mm

* Subject to individual site conditions and wind loads. Contact AWS Technical Support for more information, e-mail techsupport@awsaustralia.com.au

TYPICAL CONFIGURATIONS

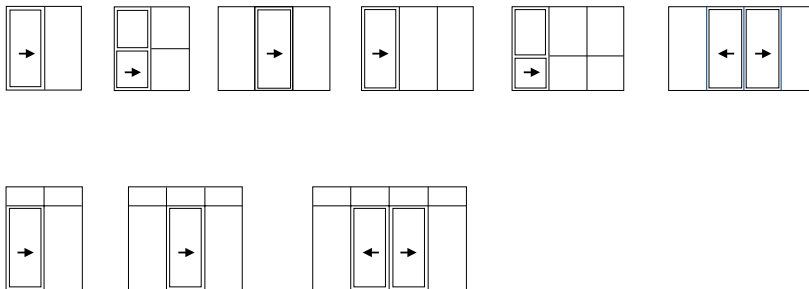

Series 541

Residential Sliding Door

DATE: NOV 09
 REPLACES: AUG 03
 SCALE: NOT TO SCALE



SOUND REDUCTION

A number of glass combinations have been tested in this sliding door. During testing the door was fitted with 'Qlon' seals vertically and weatherpile horizontally

Glass Description		
4mm Toughened glass	27dB(A)	RW28
6.38mm Laminated glass	32dB(A)	RW32
10.38mm Laminated glass	34dB(A)	RW35
20mm Insulating glass unit	33dB(A)	RW33



WERS RATINGS

Single Glazed

Glass Description	COOLING	HEATING	Uw	SHGCw	Tvw	Inf
5mm Grey	31%	10%	6.2	0.53	0.43	1.65
5mm EverGreen	34%	8%	6.2	0.49	0.62	1.65
6.38mm Laminate	18%	18%	6.1	0.68	0.76	1.65
6.38mm Solect	36%	38%	4.3	0.58	0.69	1.65
6.38mm Comfort Plus	47%	30%	4.3	0.44	0.50	1.65

Double Glazed

Glass Description	COOLING	HEATING	Uw	SHGCw	Tvw	Inf
4Clr/10Gap/4Clr	36%	42%	4.0	0.60	0.64	1.65
4Az/10Gap/4EA	59%	35%	3.4	0.33	0.49	1.65
4Clr/10Ar/4EA	43%	50%	3.1	0.57	0.59	1.65
4Clr/10Gap/4EA	42%	47%	3.4	0.56	0.59	1.65
5Clr/8Gap/5Clr	37%	40%	4.1	0.59	0.63	1.65
5EG/8Ar/5EA	59%	36%	3.3	0.34	0.48	1.65



2D & 3D CAD FILES AVAILABLE

GO TO: www.vantagealuminium.com.au > CAD & Revit 3D Files

CAD file: DWG or DXF VAN_541



MORE INFORMATION

For the latest updates regarding this product visit our website

www.vantagealuminium.com.au

HOW TO SPECIFY

SYSTEM NAME

Vantage Series 541 Residential Sliding Door

FINISH

Powder Coat

Anodised

COLOUR

Select from the Vantage range of approved powder coat or anodising colours

GLASS

Specify thickness ≤ 20mm

Specify thermal performance where applicable (Uv & SHGC)

Specify acoustic performance where applicable (RW)

HARDWARE

Refer to hardware selection guide for compatible options



Specification Assistance

Need help specifying this product? email techsupport@awsaustralia.com.au and our qualified technical advisors will assist you with product selection and specification for your project.

Series 541 Residential Sliding Door

DATE: NOV 09
REPLACES: AUG 03
SCALE: NOT SCALE

SPECIFIERS CHECKLIST

Not all sliding doors are the same. If you want your doors to perform, keep the elements on the outside where they belong and operate smoothly for years to come there are some things you should check/compare when choosing your supplier - compare us with the others.

FEATURE	Series 541	Opposition
Does the door comply with the relevant Australian Standards. All doors should comply but it pays to ask for written proof.	YES	
Coastal installations can be upgraded to 300 Pa (high) water rating.	YES	
Direction of slide can easily be changed without major surgery. If the home owner should change their mind on the direction of slide after the doors are installed it's possible to easily re-hand the door.	YES	
Heavy duty tubular sill strong enough to carry wheel chairs and heavy door panels.	YES	
Heavy duty corrosion resistant hardware We offer a large range of locks including double tongue locks. ANDO™ locks come standard with powder coated 304 SS external pull handles. Heavy duty rollers matched to the wheel rail ensure maximum wear and silent running.	YES	
Heavy door panels including double glazed can be fitted with double bogey wheels.	YES	
Flydoors run on the outside. Externally fitted flyscreens keep insects outside where they belong and make access to and operation of glazed panels easier.	YES	
Interlock on trailing edge of barrier flydoors. When these barrier flydoors are closed and locked they should also be interlocked at the meeting stile to reduce the chance of them being pulled off the track.	YES	
Sliding door can be coupled to any Vantage window without visible rivets.	YES	
The sill drainage holes are covered. Many sliding doors leak a lot of air through the sill area either through open drain holes or poorly sealed doors. A well sealed door will reduce heating and cooling costs.	YES	
Protected running tracks. A sliding door will only operate smoothly if the running rails are protected. If these rails get damaged by shoe scuffing the nylon wheel will deteriorate quickly then cause major damage to the frame. This is the most common cause of sliding door failure and if left unattended usually results in the need for a completely new door unit to be installed. Always keep the sill clean and protect the running rails - On the Series 541 door you will notice that both glass and flydoor rails are recessed for protection.	YES	
Double weatherpile. Our sliding door is double weatherpile all round to reduce air infiltration which in turn improves the water resistance. Basically doors don't rattle if they have weatherpile both sides.	YES	
Rounded corner on the frame and sash members wherever possible. Modern paint finishes don't like sharp corners.	YES	
Optional tall bottom rail. For added impact we can fix extra tall 92mm bottom rails in lieu of standard 52mm rails.	YES	

Series 541 Residential Sliding Door

DATE: NOV 09
REPLACES: OCT 04
SCALE: NOT TO SCALE

DESIGN FEATURES

1. Successfully tested for compliance with Australian Standard AS 2047.
2. Optional meeting stile strengths cover a large variety of design wind load areas.
3. The meeting stiles have been designed to withstand high wind loads, and equally important the lock stile has enough body strength to carry the lock and not flex excessively while opening and closing the door.
4. Two heavy duty sill options - One for standard water performance and a slightly taller sump type sill for high water performance.
5. Low line nursing home sill option also available, shown later in these notes.
6. Flydoors slide on the outside and run on large diameter wheels.
7. Glass door external meeting stile has built-in interlock to accept the flydoor interlock.
8. The glass door and flydoor rolling tracks are protected from accidental damage by the splayed threshold.
9. Panels can be re-handed on site (slide direction reversed).
10. Door panels can be glazed with thick or insulating glass units.

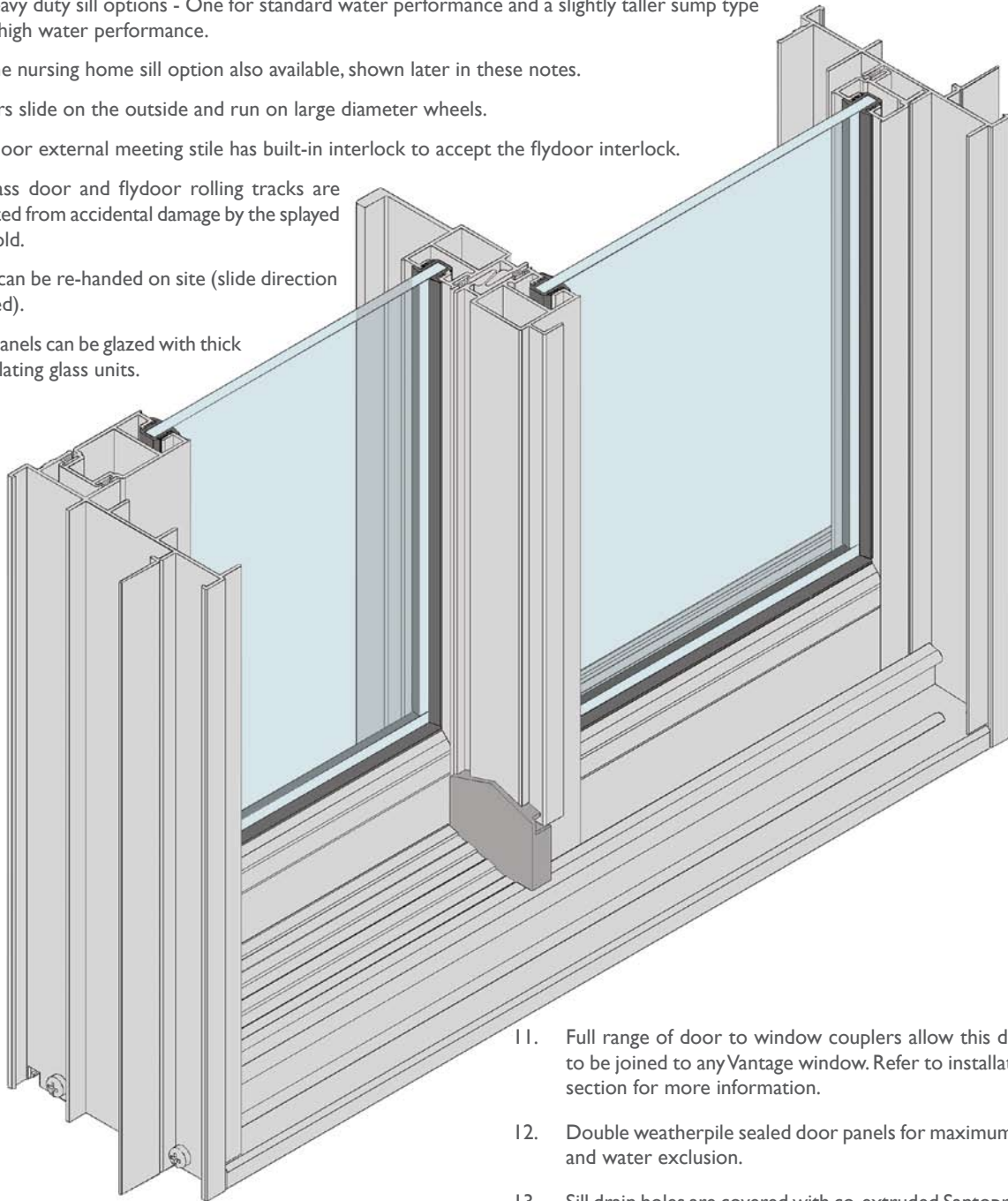

11. Full range of door to window couplers allow this door to be joined to any Vantage window. Refer to installation section for more information.
12. Double weatherpile sealed door panels for maximum air and water exclusion.
13. Sill drain holes are covered with co-extruded Santoprene hinge flap to reduce air and insect infiltration.
14. For very high performance or larger doors refer to MAGNUM™ Series 618 or SlideMASTER™ Series 704 in AWS Commercial.

Series 541 Residential Sliding Door

DATE: NOV 09
REPLACES: NOV 06
SCALE: FULL SIZE

GLAZING OPTIONS

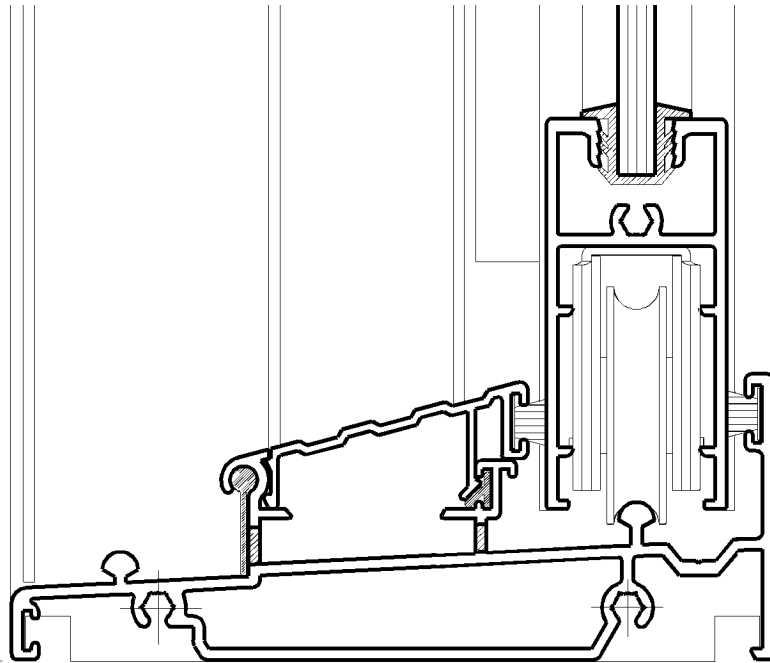

Standard

Aluminium door components wrap around the glass.

This tubular sill has been designed to resist deflection as the doors are opened and closed.

Standard 52mm bottom rail illustrated. Optional 92mm bottom rail available.

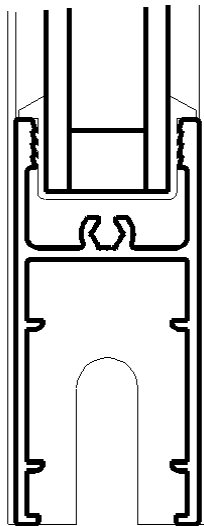

We have dedicated panel sections to accept:

- 8.38mm Laminated**
- 10.38mm Laminated**

or

- 16mm Double glazing**

as shown left

All of these heavy panels would be fitted with double bogey wheel as shown below.

20mm Double Glazed

20mm Insulating glass panel inlay adaptor, door also runs on double bogey wheels.

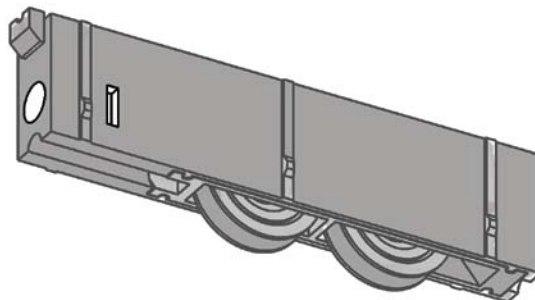
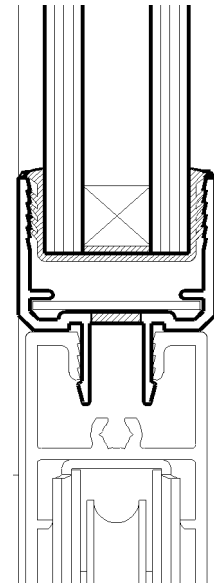

Series 541 Residential Sliding Door

DATE: NOV 09
REPLACES: AUG 03
SCALE: FULL SIZE

VERTICAL SECTION THROUGH OPENING PANEL

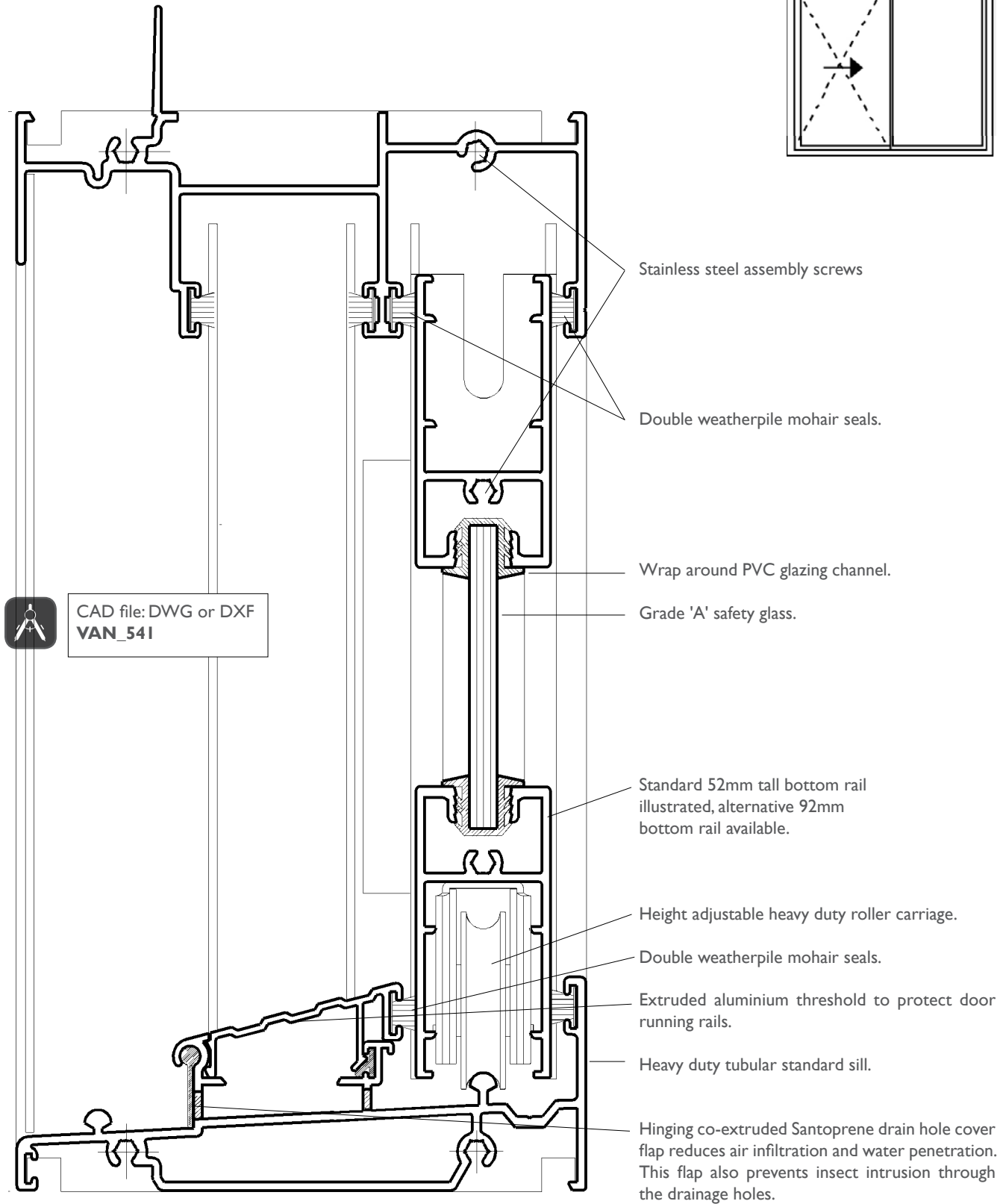

150 Pa Water rated sill

Series 541 Residential Sliding Door

DATE: NOV 09
REPLACES: NOV 06
SCALE: FULL SIZE

HIGH PERFORMANCE SILL & LOCK OPTIONS

300 Pa Water rated

Important Note:

This tubular high performance sill is 50mm high, 12mm higher than the standard sill.



CAD file: DWG or DXF
VAN_541

Double weatherpile mohair seals.

Drainage holes.

When screwing down through the sill use this recess and seal the screw to the sill.

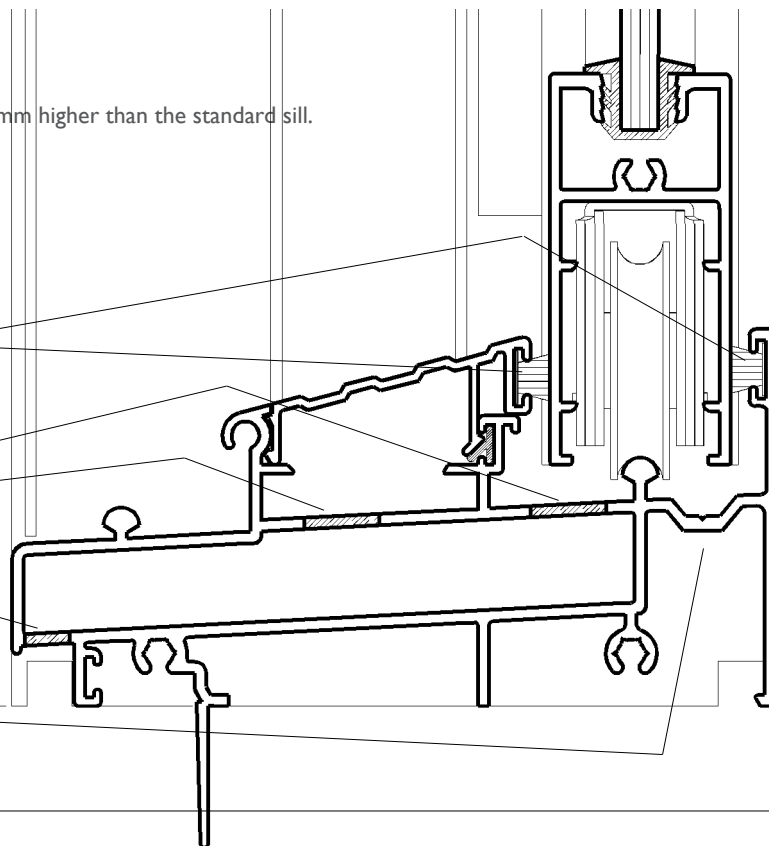

LOCKING OPTIONS

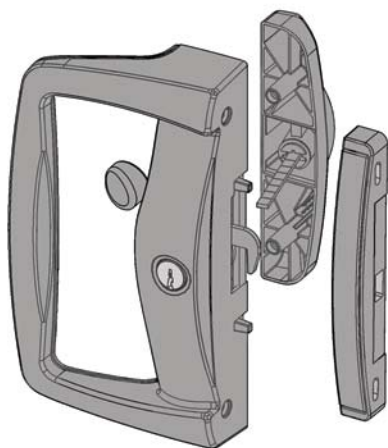

ando

Standard Vantage ANDO™ double cylinder single point deadlock

The standard colours for this lock are black, beige, white, primrose and AWS silver, the lock is also available in special colours to match the framing. Powder coated 304 SS external pull handle standard on ANDO™ locks



ando

Alternative Vantage ANDO™™ double cylinder two point deadlock

Available in standard painted colours and special colours for the ultimate finish. We also offer polished Stainless Steel.

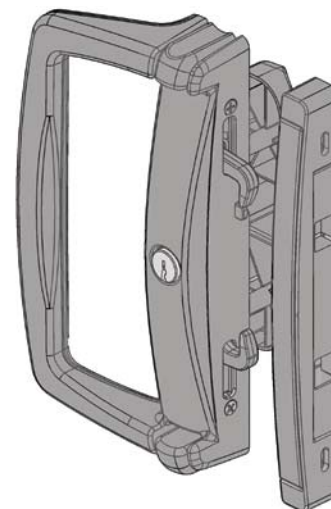

Both of these locks plus their features can be seen on our web site: www.vantagealuminium.com.au

SLIDING DOOR HORIZONTAL SECTION

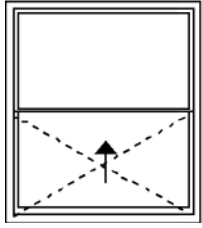

CAD file: DWG or DXF
VAN_541

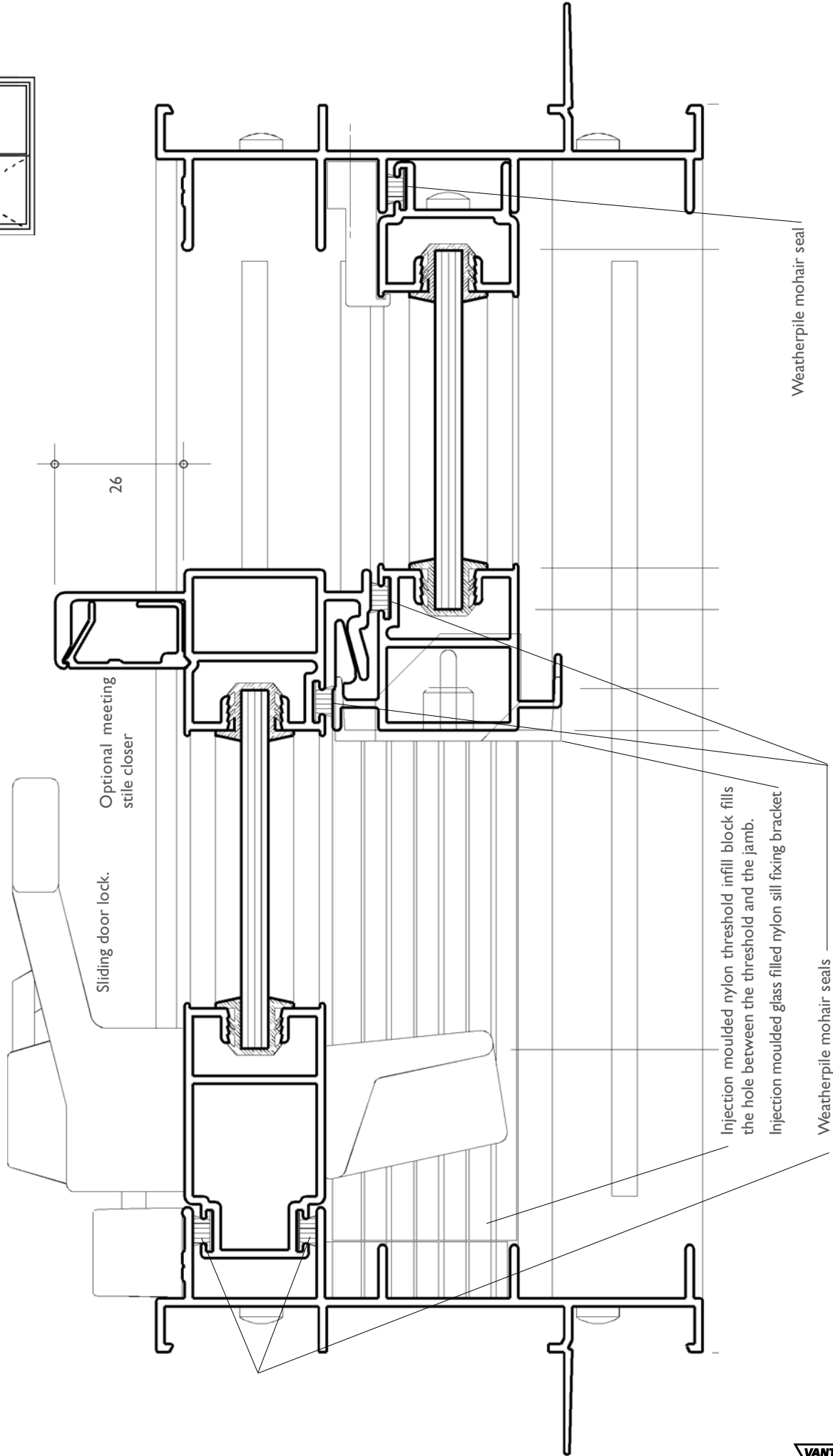

Series 541 Residential Sliding Door

DATE: NOV 09
 REPLACES: NOV 06
 SCALE: QUATER FULL SIZE

HORIZONTAL SECTION THROUGH SLIDING DOORS

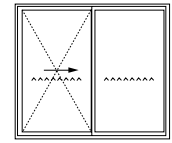
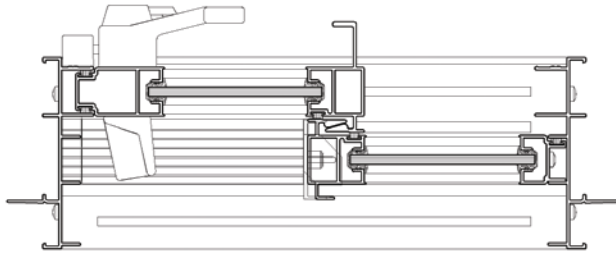

type. **XF**

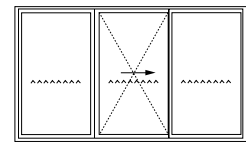
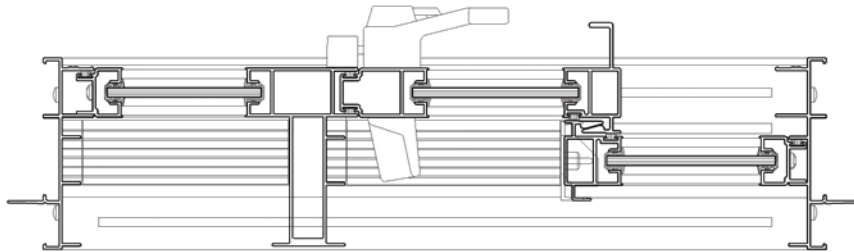

type. **FXF**

The type 'FXF' door shown above can also be assembled as type 'XFF' as shown below or 'FFX'.

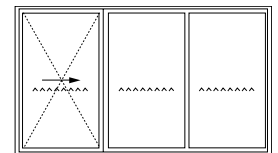
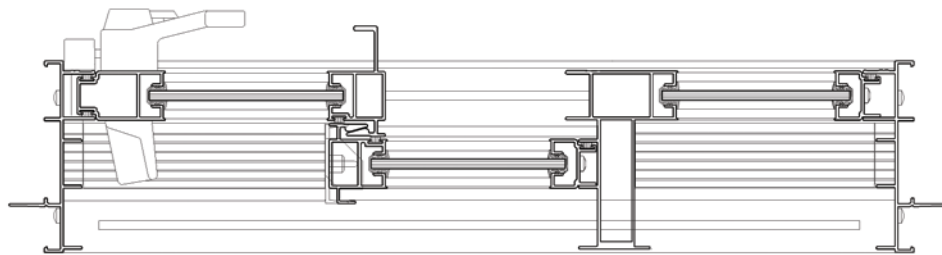

type. **XFF**

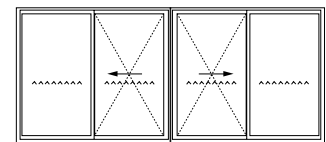

type. **FXXF**

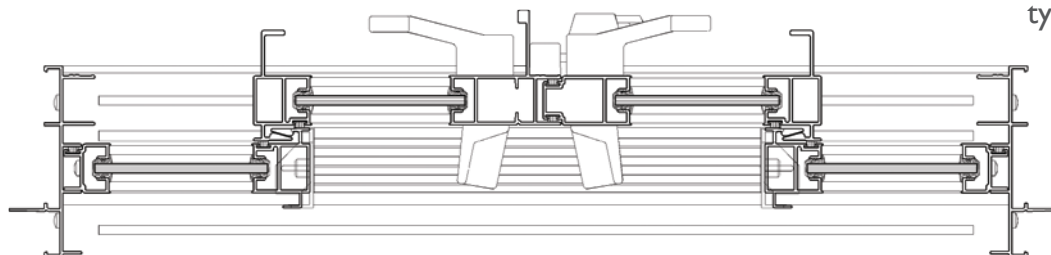

Series 541 Residential Sliding Door

DATE: NOV 09
REPLACES: AUG 03
SCALE: FULL SIZE

LOWLINE NURSING HOME SILL

Design features:

- Suits wheel chair and walking frame access.
- Minimal ramp up.
- **Doors don't comply with AS2047 on water resistance** but the sill as been designed to drain water out of the system.
- Heavy duty tubular sill will withstand the weight of wheel chairs without crushing under the load.
- Frame will accept screen door system designed to stay on the track when opened from wheel chair height.
- Doors can be glazed with toughened or laminated grade 'A' safety glass in accordance with AS1288.
- Doors can be fitted with 68mm or 100mm chair rail if required.
- The clear door opening should be 800mm minimum.
- Optional 92mm tall bottom rail.

Builder Please Note:

- To protect these lowline sills the door must be set back from the eaves line by a minimum of 1600mm.
- The floor must be recessed as detailed to allow the sill to be flush with floor line on the inside.
- If the sill is not recessed an approved ramp will be provided on the inside by the builder.

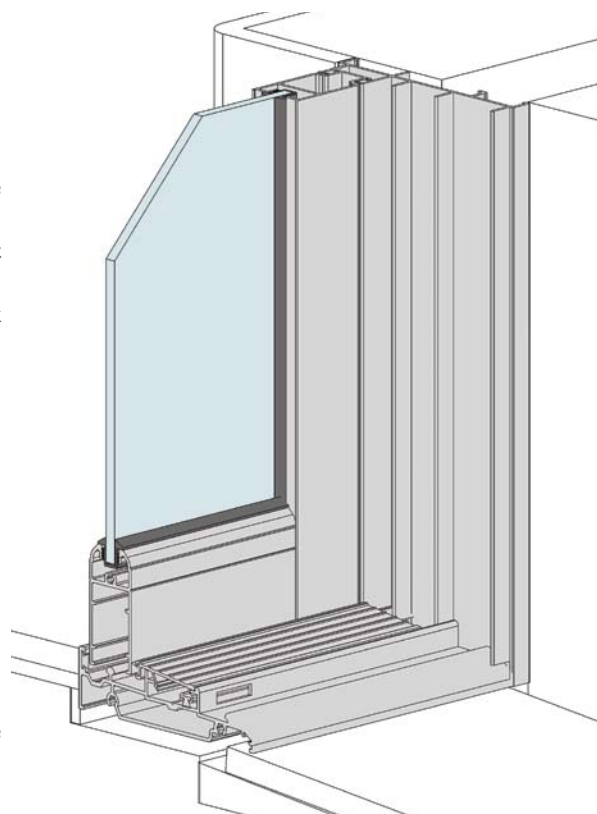

CAD file: DWG or DXF
VAN_541

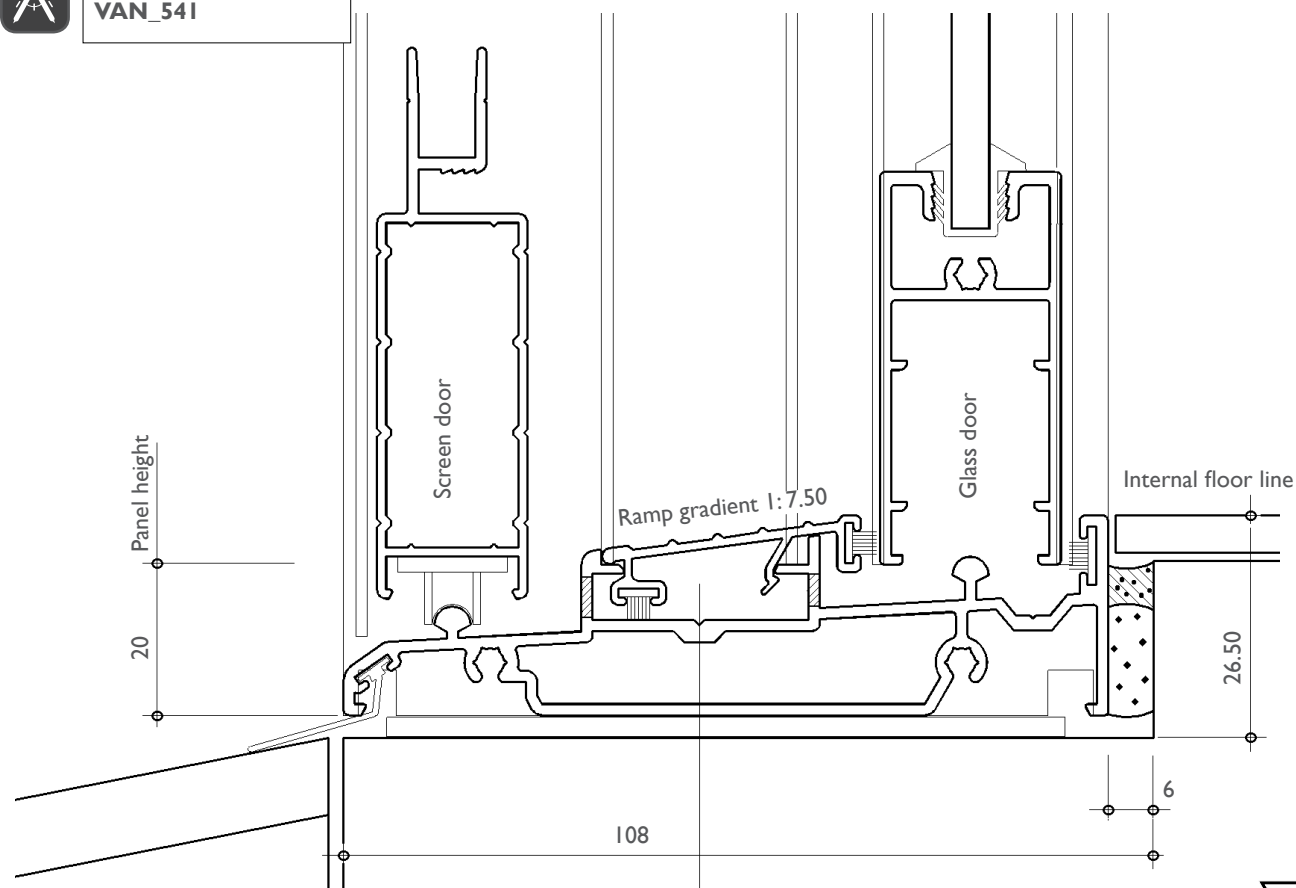

Series 541 Residential Sliding Door

DATE: NOV 09
REPLACES: AUG 03
SCALE: FULL SIZE

PERFORMANCE AND DOUBLE GLAZING

Meeting Stile Strength

This table shows a range of serviceability ratings (I/150) that can be achieved:

type code	Height mm	Width mm	Meeting Stiles			Panel Weight	
			Light	Medium	Heavy	5mm Glass	20mm IGU (5-10-5)
XF	2100	1810	669 Pa	1021 Pa	1941 Pa	25.24 Kg	43.66 Kg
XF	2100	2110	585 Pa	894 Pa	1700 Pa	29.11 Kg	51.07 Kg
XF	2100	2410	526 Pa	803 Pa	1528 Pa	32.98 Kg	58.48 Kg

For other sizes/types refer full Pascal rating tables on web site.

Double Glazing

20mm Insulating glass made up of two sheets of 5mm toughened glass with 10mm air space.

16mm IGU's made up of two sheets of 4mm toughened glass with 8mm air space come with dedicated rails and stiles - no adaptor channel (as shown earlier).

Wrap around PVC glazing channel.

Double bogey roller assembly .

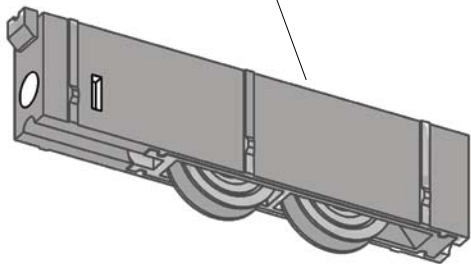

Heavy duty tubular sill capable of carrying double glazed door panels without dipping between sill installation shims.

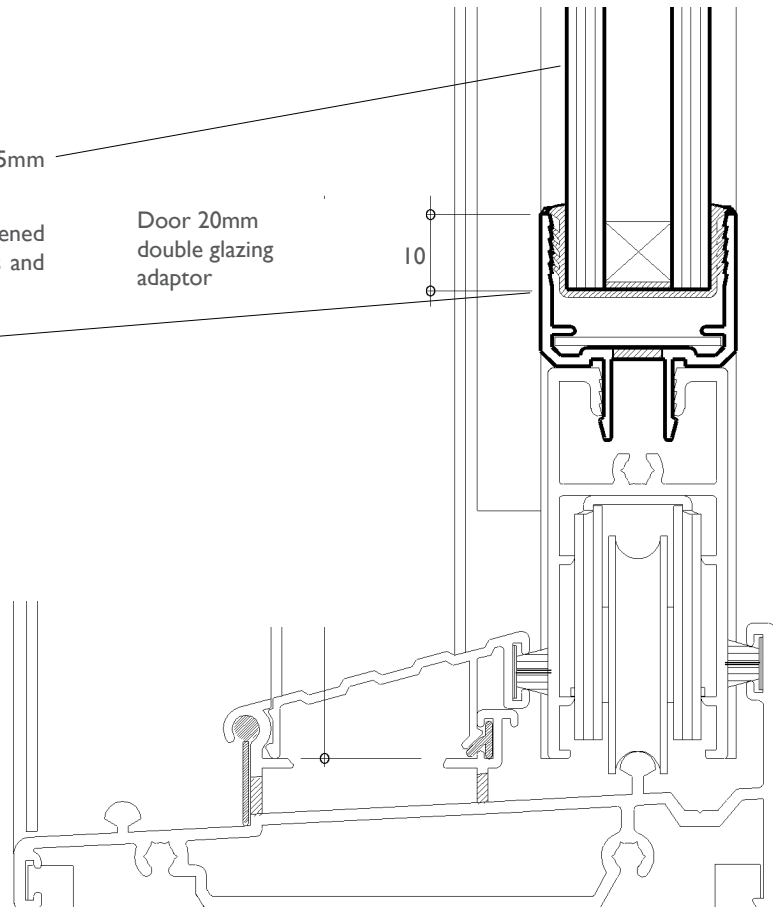

Series 541 Residential Sliding Door

DATE: NOV 09
REPLACES: AUG 03
SCALE: FULL SIZE

COUPLERS AND FLYSCREEN DOOR

EF Adaptor

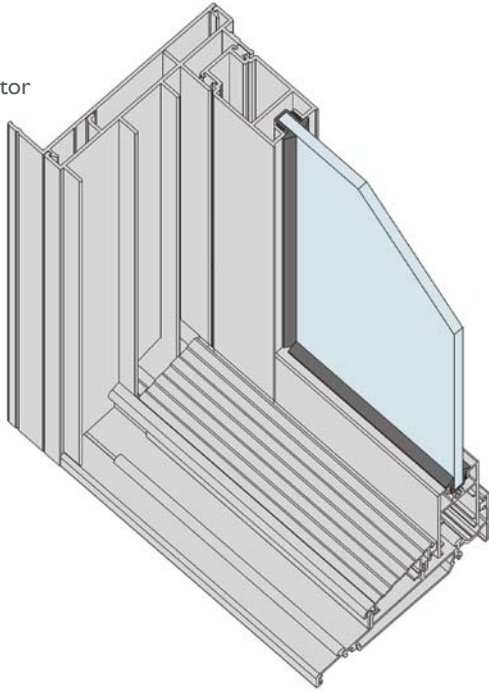

Some of the couplers and trims offered:

- 135° Bay coupler for 102mm windows or 102mm doors.
- 90° Corner coupler for 102mm windows or 102mm doors.
- 180° Coupler for 102mm doors.
- 'Longreach' frame extender.
- 'Homebush' frame extender (illustrated right).
- 'Paddington' federation trims.
- Storm moulds.
- Architraves.
- External flange adaptors (illustrated above).
- Flat jamb closer.



CAD file: DWG or DXF
VAN_COUPLERS

'Homebush' frame extenders on jambs.

Refer to installation section for more information

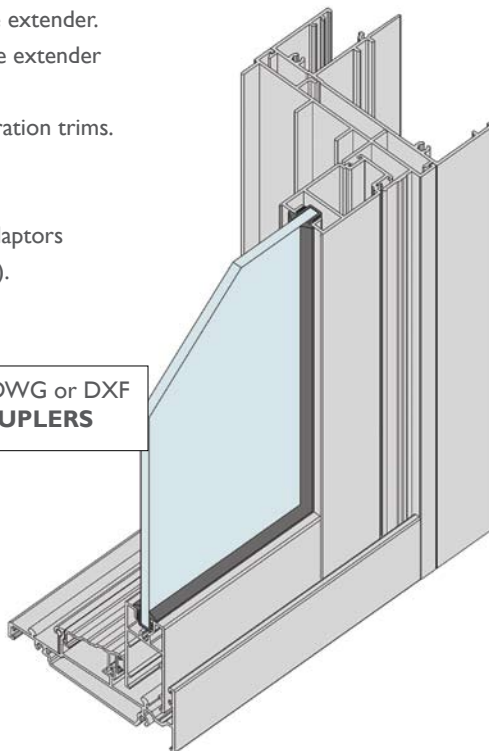

Vantage offer a large range of snap on couplers and trims,

The detail below shows the custom extruded flydoor that can be fitted to Series 541 sliding doors.

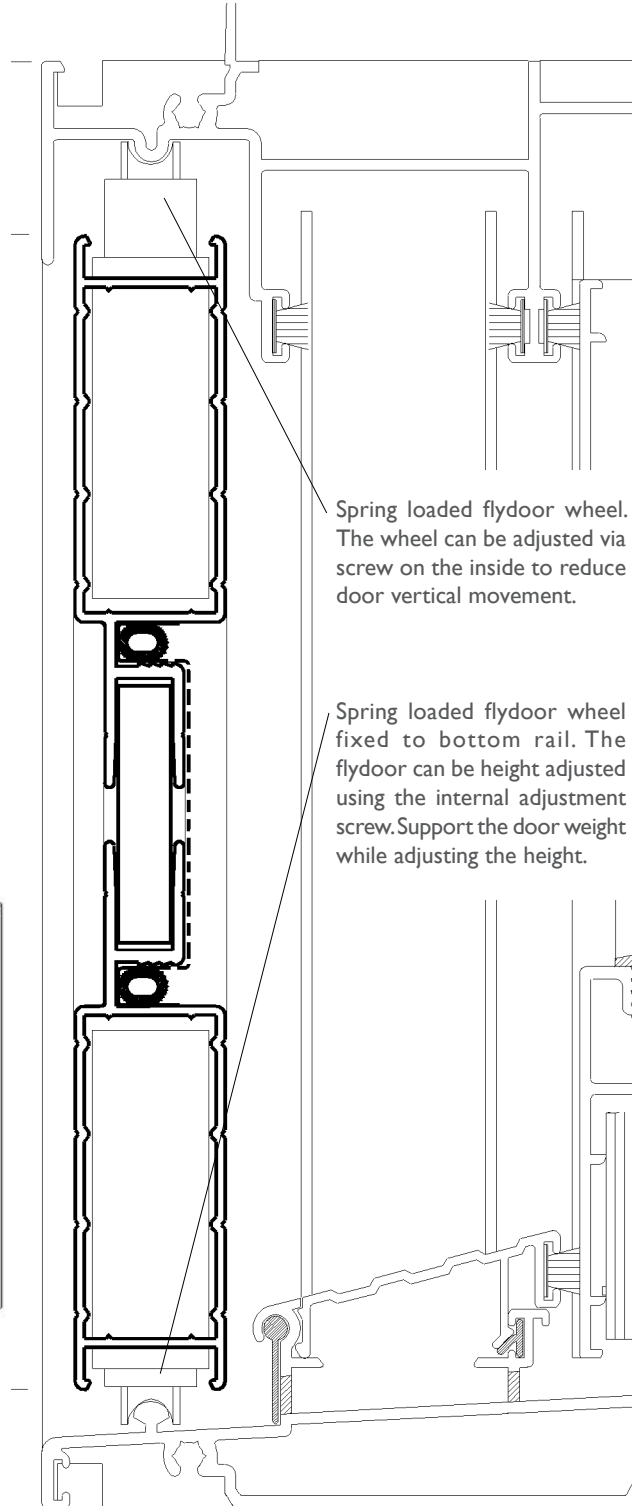

Spring loaded flydoor wheel. The wheel can be adjusted via screw on the inside to reduce door vertical movement.

Spring loaded flydoor wheel fixed to bottom rail. The flydoor can be height adjusted using the internal adjustment screw. Support the door weight while adjusting the height.

Series 541 Residential Sliding Door

DATE: NOV 09
REPLACES: NOV 06
SCALE: NOTED BELOW

ALTERNATIVE SLIDING DOOR SlideMASTER™ Series 702 High Performance Commercial Stacking Sliding Door

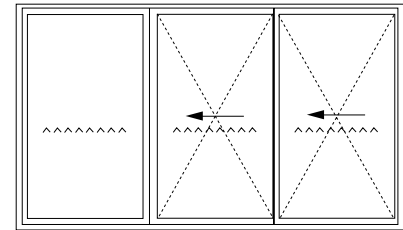
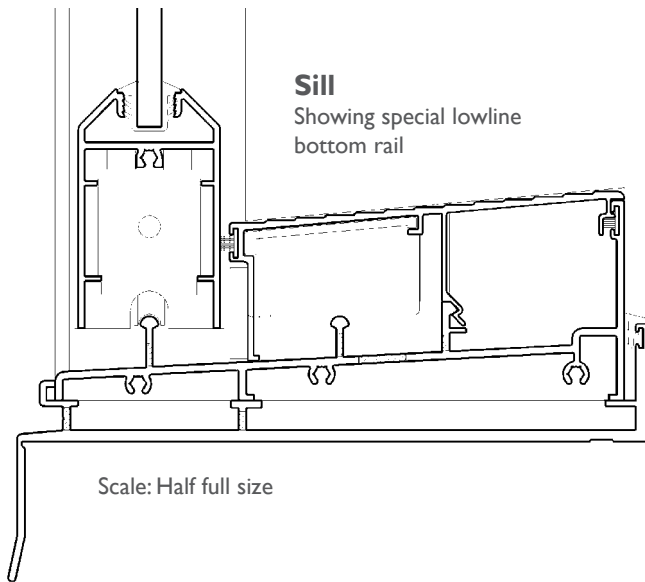

Alternative Commercial Sliding Door

If you are looking for a stronger, higher performance, bolder sliding door consider the AWS SlideMASTER™ Series 702.

Features overview:

- 102mm and 150mm Frame widths
- Can be fabricated as 'XF, FXF, FXXF, XXF' and 'FXXXXF' stacking doors.
- Very high water resistance.
- Stronger panels allow door heights up to 3000mm.
- Compatible with AWS FrontGLAZE™ Commercial framing.



Refer AWS Commercial Specifier Manual for more details. Coloured animated images can be seen on AWS web site: www.awscommercial.com.au

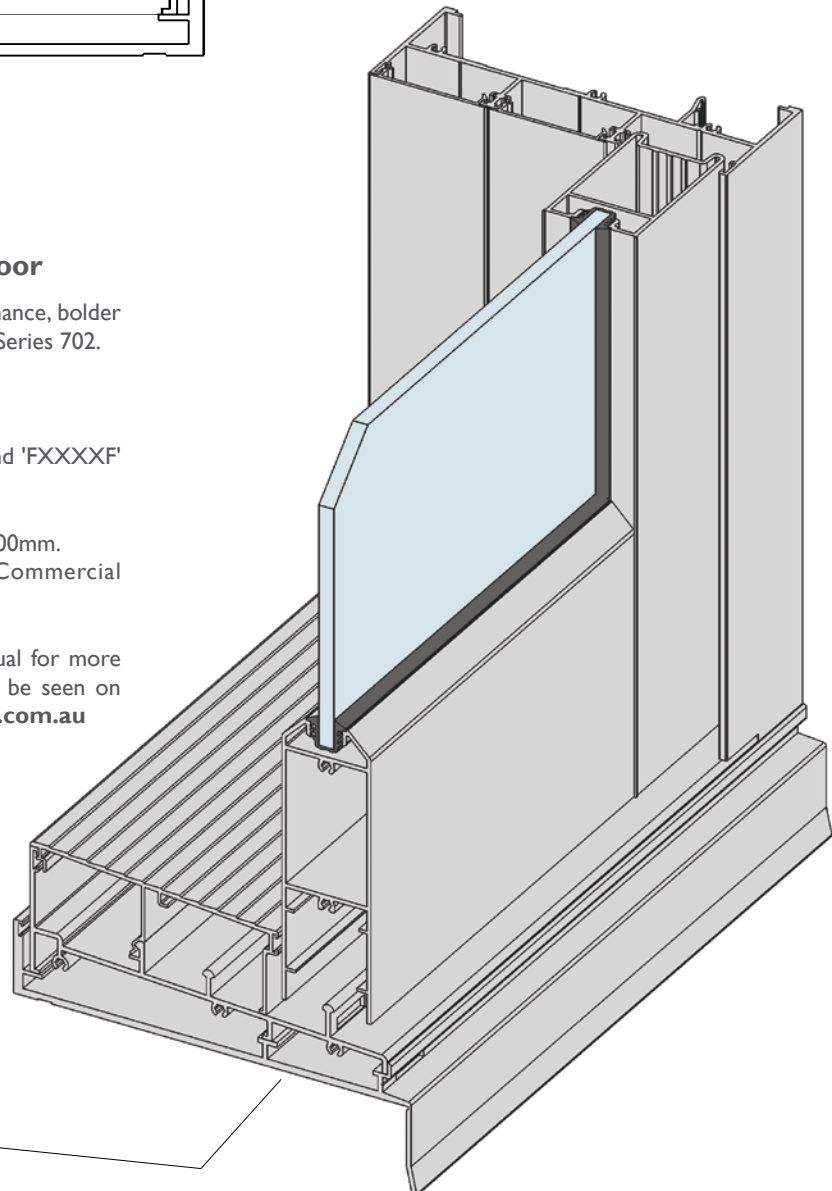

SlideMASTER™ doors are designed to go into sub sills as illustrated

Series 541 Residential Sliding Door

DATE: NOV 09
REPLACES: NOV 06
SCALE: NOTED BELOW

ALTERNATIVE SLIDING DOOR SlideMASTER™ Series 704 Architectural Commercial Stacking Sliding Door

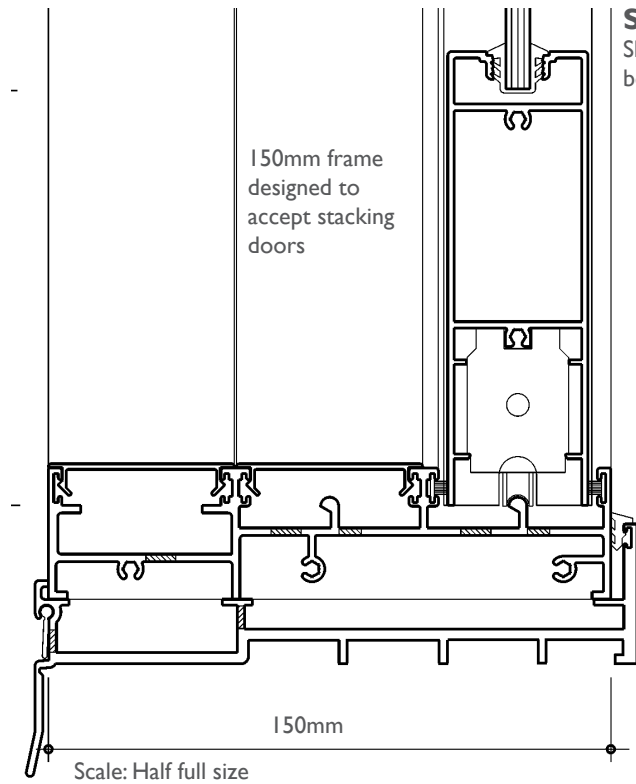

Sill
Showing standard tall bottom rail.

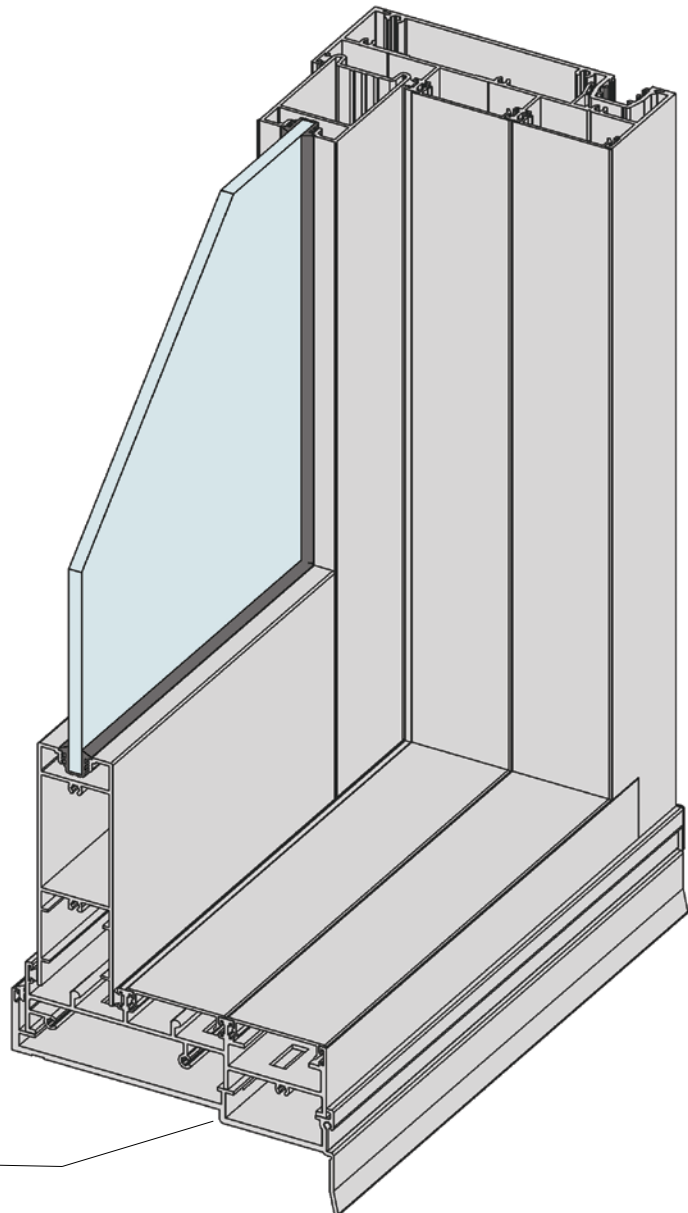
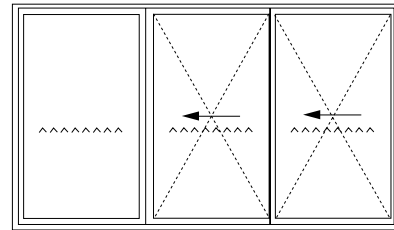

Alternative Architectural Commercial Sliding Door

If you are looking for a stronger, bolder sliding door consider the AWS SlideMASTER™ Series 704.

Features overview:

- 102mm and 150mm Frame widths.
- Can be fabricated as 'XF', 'FXF', 'FXXF', 'XXF' and 'FXXXXF' stacking doors.
- Very high water resistance.
- Stronger panels allow door heights up to 3000mm.
- Compatible with AWS FrontGLAZE™ commercial framing.



Refer AWS Commercial Specifier Manual for more details. Coloured animated images can be seen on AWS web site: www.awscommercial.com.au

Another feature:
The sub-sill under 150mm frame has an additional support at mid span to support the middle door panel.

Series 541 Residential Sliding Door

DATE: NOV 09
REPLACES: NOV 06
SCALE: HALF FULL SIZE

ALTERNATIVE SLIDING DOOR MAGNUM™ 618 Stacking Sliding Door

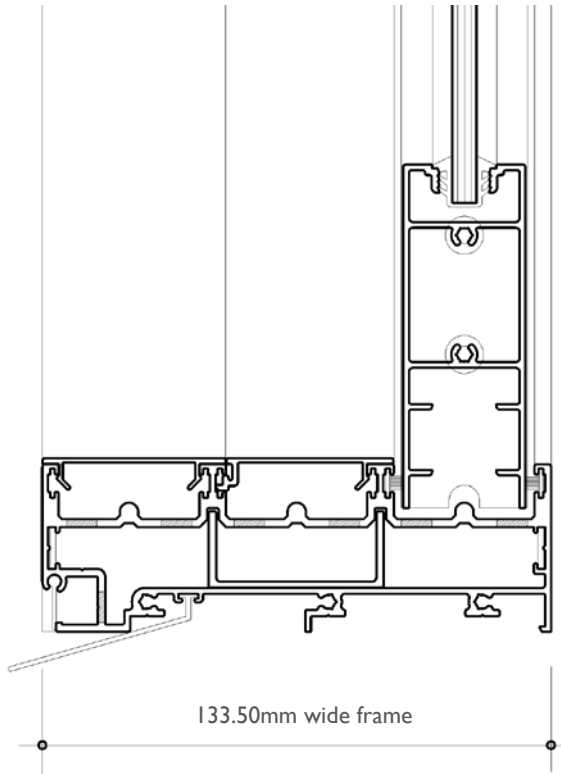

Sill

Showing standard tall bottom rail.

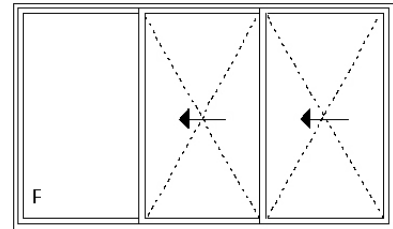

Alternative MAGNUM™ 618 Sliding Door

If you are looking for a stronger, bolder residential sliding door consider the MAGNUM™ 618 Sliding door

Features overview:

- 133mm Frame width.
- Can be fabricated as 'XF', 'FXF', 'FXXF', 'XXF', 'FXXXXF', 'XXXXF', and 'FXXXXXXF' plus cavity sliding doors .
- Very high water resistance, subsill not required.
- Stronger panels allow door heights up to 2700mm.
- Compatible with MAGNUM™ Designer Series windows and doors

Refer Designer Series section of this manual for more details.



Coloured animated images can be seen on Vantage web site: www.vantagealuminium.com.au

