

Series 726 Thermally Broken Awning Window



Photo courtesy of MidCity Windows



Series 726 Thermally Broken Awning Window

DATE: NOV 09
REPLACES:
SCALE: NOT TO SCALE

KEY FEATURES / PERFORMANCE CHARACTERISTICS

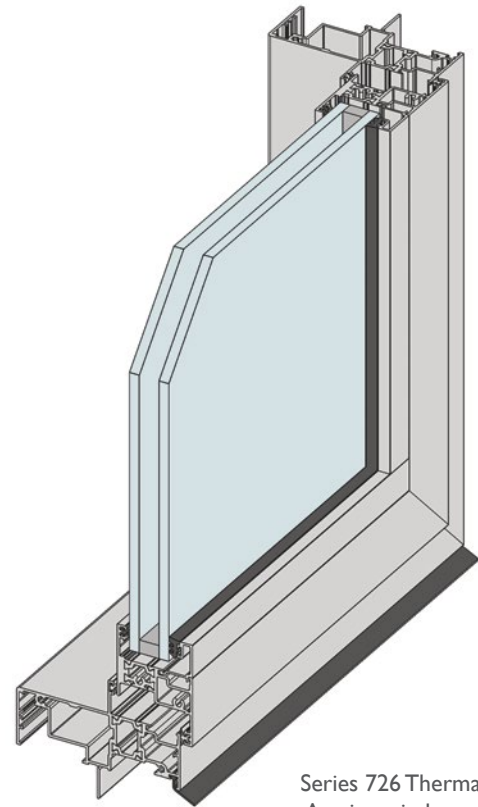

Series 726 Thermal HEART™
Awning window external view

- Series 726 incorporates ThermalHEART™ technology giving a true wide thermal break between the outside and inside faces. WERS (Window Energy Rating System) data shows that using the same IGU in a ThermalHEART™ awning is 32% more efficient than a standard non-thermally broken window.
- A major advantage with ThermalHEART™ in cold climates is the reduction in internal condensation. This saves potential damage to timber reveals and paint finishes.
- ThermalHEART™ is also suitable for hot climates - Thermally broken windows and doors will help to reduce the air conditioning load in a hot climate.
- We offer ThermalHEART™ in a range of stocked colours including dual colour ClearMIST™ (Clear anodised exterior and SurfMist powder coat interior)
- The window has been tested for compliance with the relevant Australian Standards and achieved a very high water resistance of 600Pa, this makes the product suitable for most applications including multi-storey apartments.
- Very low air infiltration, makes the product suitable for air conditioned buildings.
- The extra strong sash allow large sash windows to be fabricated for high wind load areas, refer Pascal rating tables later in these notes.

Maximum Panel Height*	2100mm
Maximum Panel Width*	1300mm
Maximum Glass Thickness	≤ 32mm

* Subject to individual site conditions and wind loads. Contact AWS Technical Support for more information, e-mail techsupport@awsaustralia.com.au

TYPICAL CONFIGURATIONS

Awning Style

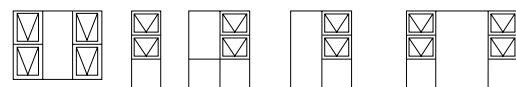
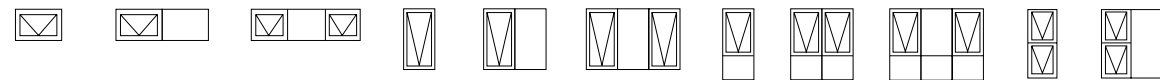

Casement Style

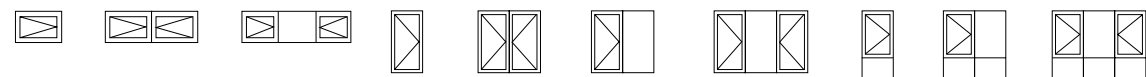

Series 726 Thermally Broken Awning Window

DATE: APR 21
REPLACES: NOV 09
SCALE: NOT TO SCALE

SOUND REDUCTION

A number of glass combinations have been tested on a similar awning window. Opening sash was fitted with Santoprene fin seal on four sides.

Glass Description		
4mm Annealed glass	30dB(A)	RW32
6.38mm Laminated glass	34dB(A)	RW34
10.38mm Laminated glass	36dB(A)	RW36
24mm Insulating glass unit	35dB(A)	RW35

WERS RATINGS

Double Glazed

Glass Description	COOLING	HEATING	Uw	SHGCw	Tvw	Inf
4Clr/10Gap/4Clr	49%	61%	3.5	0.46	0.48	0.73
4AZ/10Gap/4EA	65%	54%	3.1	0.26	0.37	0.73
4Clr/10Ar/4EA	54%	67%	2.9	0.44	0.44	0.73
4Clr/10Gap/4EA	54%	65%	3.1	0.43	0.44	0.73
5Clr/8Gap/5Clr	50%	60%	3.6	0.45	0.48	0.73
5EG/8Ar/5EA	65%	55%	3.0	0.26	0.36	0.73
3EG/12Gap/3Clr	59%	54%	3.5	0.33	0.41	0.73
3Clr/12Ar/3EA	53%	67%	2.9	0.45	0.45	0.73
6Clr/12Gap/6Clr	51%	61%	3.5	0.44	0.47	0.73
6EG/12Gap/6EA	64%	50%	3.5	0.26	0.35	0.73
6Clr/12Gap/6EA	55%	64%	3.0	0.42	0.44	0.73
6EG/12Gap/6EA	68%	53%	3.0	0.23	0.32	0.73

HOW TO SPECIFY

SYSTEM NAME

Vantage Series 726 Thermal HEART™ Awning Window

FINISH

Powder Coat
Anodised

COLOUR

Select from the ThermalHEART™ range of approved powder coat or anodising colours. Dual colour options available.

GLASS

Specify thickness < 32mm
Specify thermal performance where applicable (Uv & SHGC)
Specify acoustic performance where applicable (RW)

HARDWARE

Refer to hardware selection guide for compatible options

Specification Assistance

Need help specifying this product? email techsupport@awsaustralia.com.au and our qualified technical advisors will assist you with product selection and specification for your project.

© Architectural Window Systems Pty Ltd 2021

© Architectural Window Systems Pty Ltd 2021

MORE INFORMATION, 2D & 3D CAD FILES

For the latest updates regarding this product visit our website: specifyaws.com.au

Series 726 Thermally Broken Awning Window

DATE: NOV 09
REPLACES:
SCALE: NOT TO SCALE

SPECIFIERS CHECKLIST

Not all awning windows are the same. If you want your windows to perform, keep the elements on the outside where they belong and operate smoothly for years to come there are some things you should check/compare when choosing your supplier - compare us with the others.

FEATURE	Series 726	Opposition
True thermal break The Vantage Series 726 awning window frame and sashes are thermally broken.	YES	
Soft internal corners The Vantage Series 726 frame, mullions and transoms have 2mm internal corner radius to soften the inner appearance and remove possible unsightly sharp edges at junctions.	YES	
Thick Insulating Glass Units (IGU's) The Vantage Series 726 awning window will accept very thick IGU's up to 32mm thick. Adjoining fixed lights will also accept glass up to 32mm thick.	YES	
Will the awning window keep the water out - has it been tested? The Vantage Series 726 awning window has been successfully tested to keep water out achieving 600Pa water resistance. This allows the window to be used in most exposed areas in Australia including multi storey.	YES	
Is the product suitable for air-conditioned apartments? We came in at a fraction of the requirements of the standard making the product ideal for air-conditioned buildings.	YES	
Are the awning sashes strong enough to make large sashes in exposed locations? The 46mm thick sash can be fabricated in sashes up to 1800mm high. We have successfully tested sashes in all three hardware options to prove that the hardware can support these strong sashes. We proof tested the sash in positive and negative direction. This is not always done with competitor products. But we had to make sure the sashes would stay in the building under extreme negative loads.	YES	
High quality hardware We offer three locking options: Cam handles - Not suitable for windows requiring flyscreens. Manual chain winders - With stainless steel chain and corrosion resisting base. Electric winders - Concealed with touch pad activation. All sashes hang on heavy duty four bar stays designed to carry the weight of heavy double glazed awning or casement sashes.	YES	
Can we fit flyscreens? Flyscreens can be fitted to awning sashes with winders. The flyscreen nests into the winder base and is held against the jamb/mullion with spring nylon clips.	YES	
Can the awning frame be coupled to other thermal products? We have thermally broken couplers that allow the awning to be clipped to hinged, bi-fold or sliding doors.	YES	
Is this window designed for Australian Conditions? The Series 726 incorporates integrated nailing fins, sill seals and adjustable building in lugs. Designed to be installed into a cavity brick or brick veneer installation the same as a conventional awning window.	YES	

© Architectural Window Systems Pty Ltd 2021

© Architectural Window Systems Pty Ltd 2021

Series 726 Thermally Broken Awning Window

DATE: NOV 09
REPLACES:
SCALE: NOT TO SCALE

DESIGN FEATURES

This high performance awning/casement window has been designed to complement our other thermal products.

Series 726 incorporates ThermalHEART™ technology giving a true wide thermal break between the outside and inside faces. WERS (Window Energy Rating System) data shows that using the same IGU in a ThermalHEART™ awning is 32% more efficient than a standard non-thermally broken window.

A major advantage with ThermalHEART™ in cold climates is the reduction in internal condensation. This saves potential damage to timber reveals and paint finishes.

ThermalHEART™ is also suitable for hot climates - Thermally broken windows and doors will help to reduce the air conditioning load in a hot climate.

We offer ThermalHEART™ in a range of stocked colours including dual colour ClearMIST™ contact your local Vantage fabricator for details.

The window has been tested for compliance with the relevant Australian Standards and achieved a very high water resistance of 600Pa, this makes the product suitable for most applications including multi-storey apartments.

Very low air infiltration, makes the product suitable for air conditioned buildings.

The extra strong sash allow large sash windows to be fabricated for high wind load areas, refer Pascal rating tables later in these notes.

Sharp square external glazing beads are standard.

100mm frame, mullion and transom have a soft 2mm internal radius.

Awning sashes can be fitted with cam handles, manual chain winders or concealed electric winders. The winder options suit fixed flyscreen installation as detailed in these notes.

The Window is compatible (appearance, strength and performance) with the high performance ThermalHEART™ hinged, bi-fold and sliding doors. We have light and heavy 180° couplers that will join windows to doors without unsightly rivets or screws while maintaining the thermal break.

Fixed lowlights/sidelights use the same frame and beads as the opening sashes.

Sashes are hung on heavy duty four bar stainless steel or aluminium stays.

Sashes and sidelights will accept a variety of glass thicknesses from 4mm single panes to 32mm insulating glass units.

WERS rated product

 All of the important features are shown in full colour at: www.vantagealuminium.com.au

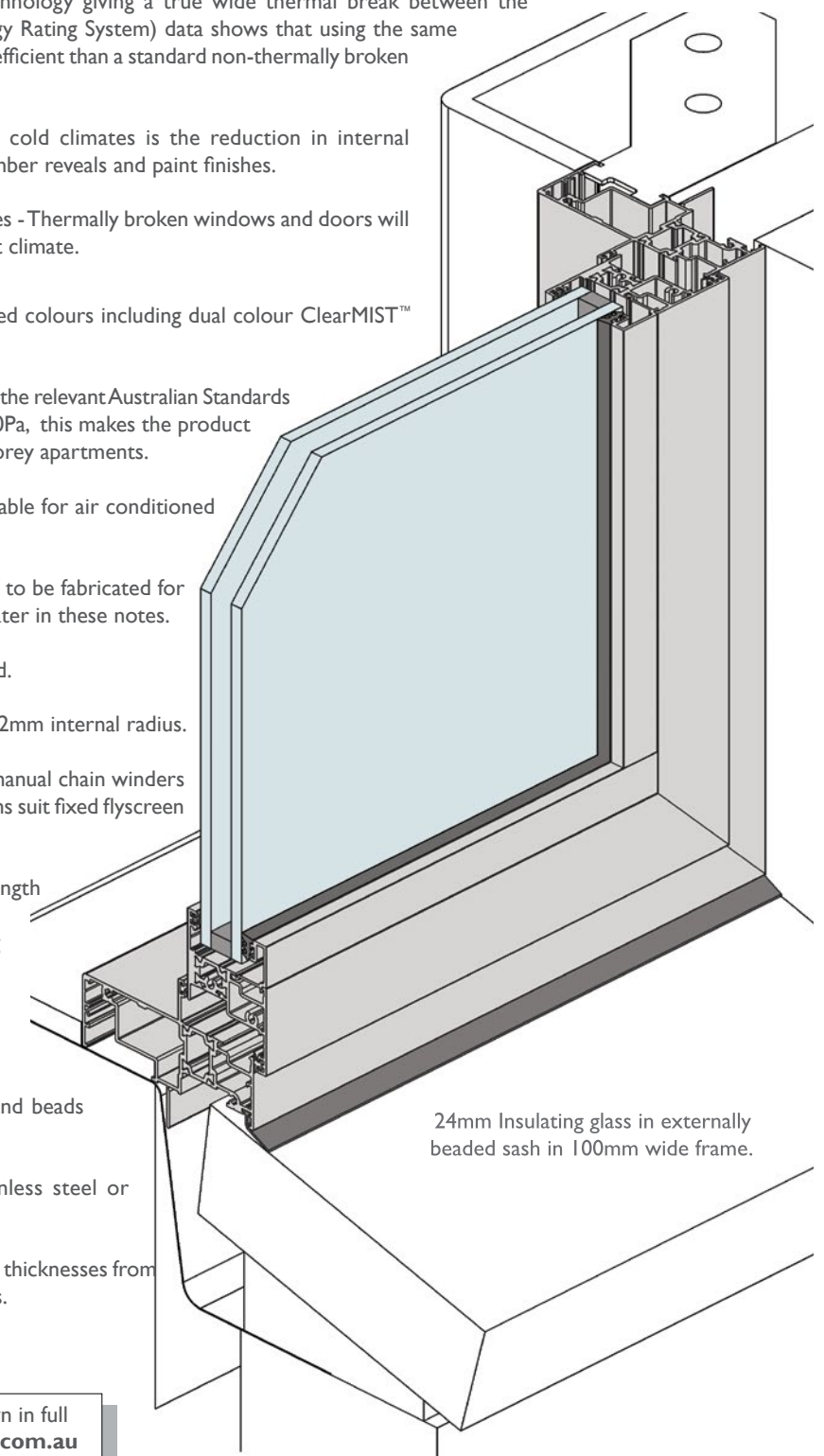

Series 726 Thermally Broken Awning Window

DATE: NOV 09
REPLACES:
SCALE: HALF FULL SIZE

PERFORMANCE

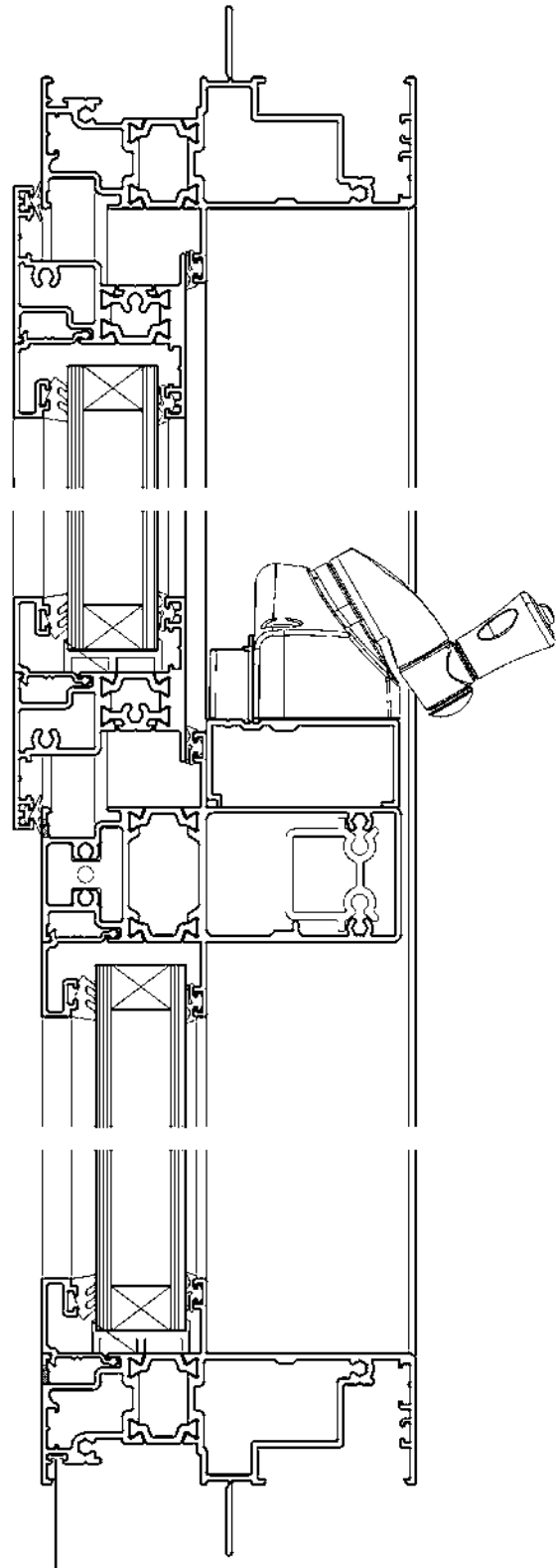

Awning sash with manual chain winder over fixed lowlight.

Sash Strength

Rating tables for sash side rails on this page.

S = Serviceability limit state (deflection = L/150).

U = Ultimate strength limit state (factored yield strength = 104 MPa).

These tables have been calculated using nominal section properties. A typical assembly has been tested as per the requirements of AS2047.

Serviceability rating has been limited to 3000 Pa and Ultimate strength rating has been limited to 4500 Pa.

Please note: There are also size and strength limitations on the sash hardware

Window Height mm	Window Width mm	Awning Sash		
		1/150 S	1/180 S	U
1400	900	1770 Pa	1770 Pa	3913 Pa
1400	1000	1582 Pa	1582 Pa	3528 Pa
1400	1100	1430 Pa	1430 Pa	3220 Pa
1400	1200	1305 Pa	1305 Pa	2970 Pa
1400	1300	1200 Pa	1200 Pa	2763 Pa
1600	900	1540 Pa	1540 Pa	2940 Pa
1600	1000	1377 Pa	1377 Pa	2645 Pa
1600	1100	1245 Pa	1245 Pa	2408 Pa
1600	1200	1136 Pa	1136 Pa	2215 Pa
1600	1300	1044 Pa	1044 Pa	2054 Pa
1800	900	1341 Pa	1117 Pa	2291 Pa
1800	1000	1206 Pa	1005 Pa	2058 Pa
1800	1100	1097 Pa	914 Pa	1871 Pa
1800	1200	1005 Pa	840 Pa	1718 Pa
1800	1300	924 Pa	779 Pa	1590 Pa

Wind Ratings (Pa) sashes.

© Architectural Window Systems Pty Ltd 2021

Series 726 Thermally Broken Awning Window

DATE: NOV 09
REPLACES:
SCALE: HALF FULL SIZE

ALTERNATIVE GLAZING

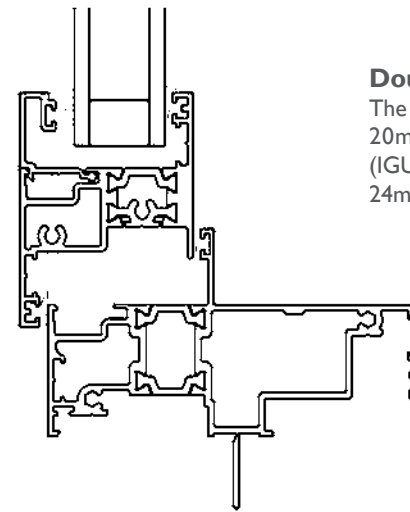

Double Glazing Alternatives

The wide thermally broken sash will accept 20mm to 32mm Insulating Glass Units (IGU's).
24mm Illustrated left.



CAD file: DWG
VAN_726

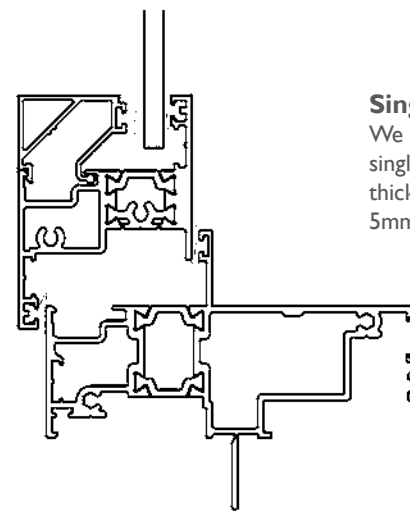

Single Glazing Alternatives

We have also cut glazing beads to accept single panes of glass from 4mm to 10.38mm thick.
5mm Illustrated left.

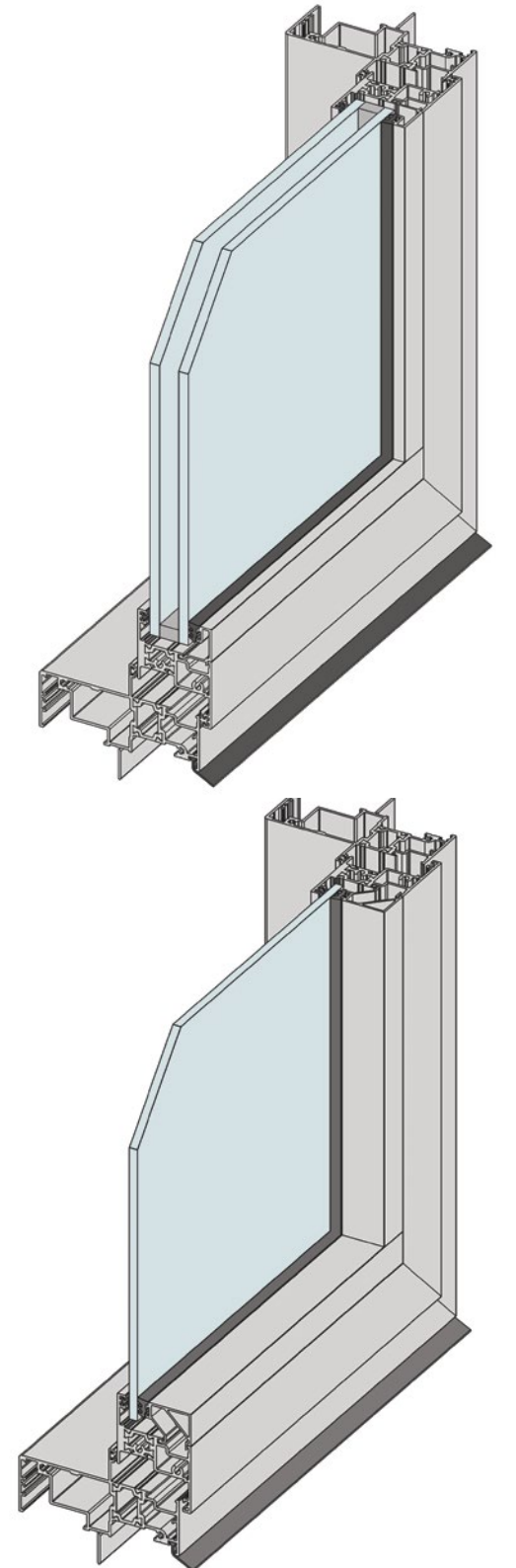

Series 726 Thermally Broken Awning Window

DATE: NOV 09
REPLACES:
SCALE: HALF FULL SIZE

VERTICAL CROSS SECTION INTO BRICK VENEER WALL

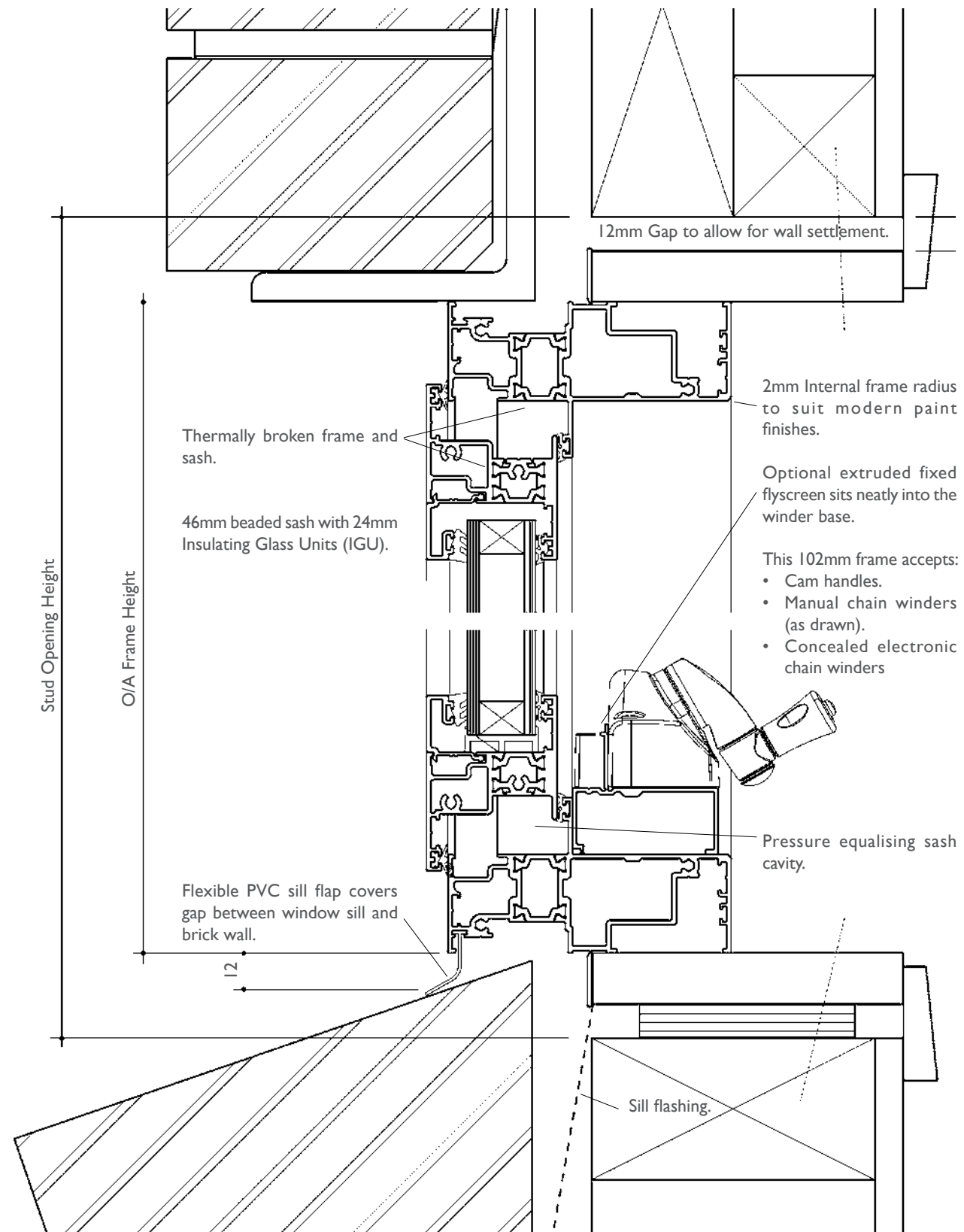

© Architectural Window Systems Pty Ltd 2021

Series 726 Thermally Broken Awning Window

DATE: NOV 09
REPLACES:
SCALE: HALF FULL SIZE

HORIZONTAL CROSS SECTION INTO BRICK VENEER WALL

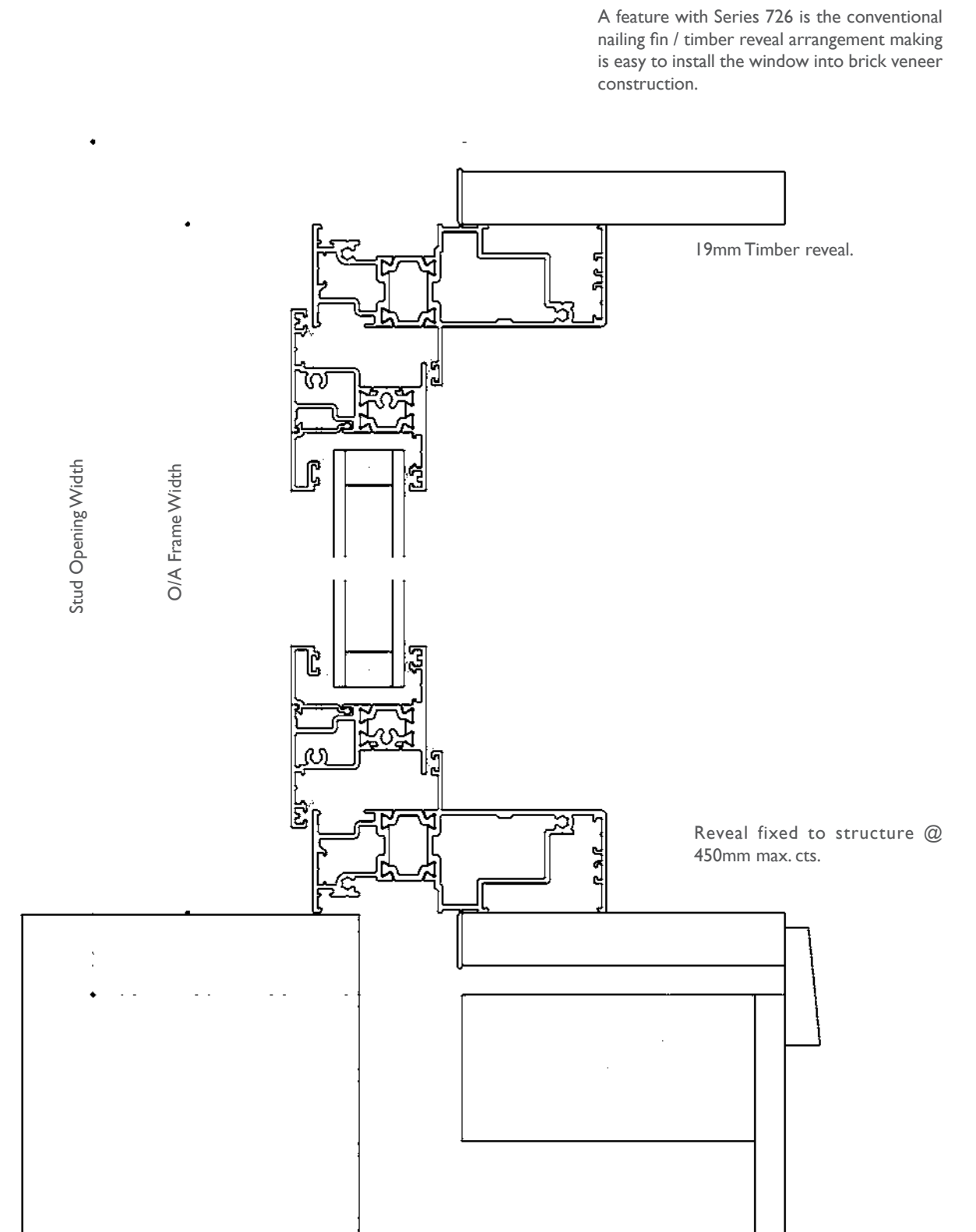

© Architectural Window Systems Pty Ltd 2021

Series 726 Thermally Broken Awning Window

DATE: NOV 09
REPLACES:
SCALE: HALF FULL SIZE

VERTICAL CROSS SECTION INTO CAVITY BRICK WALL

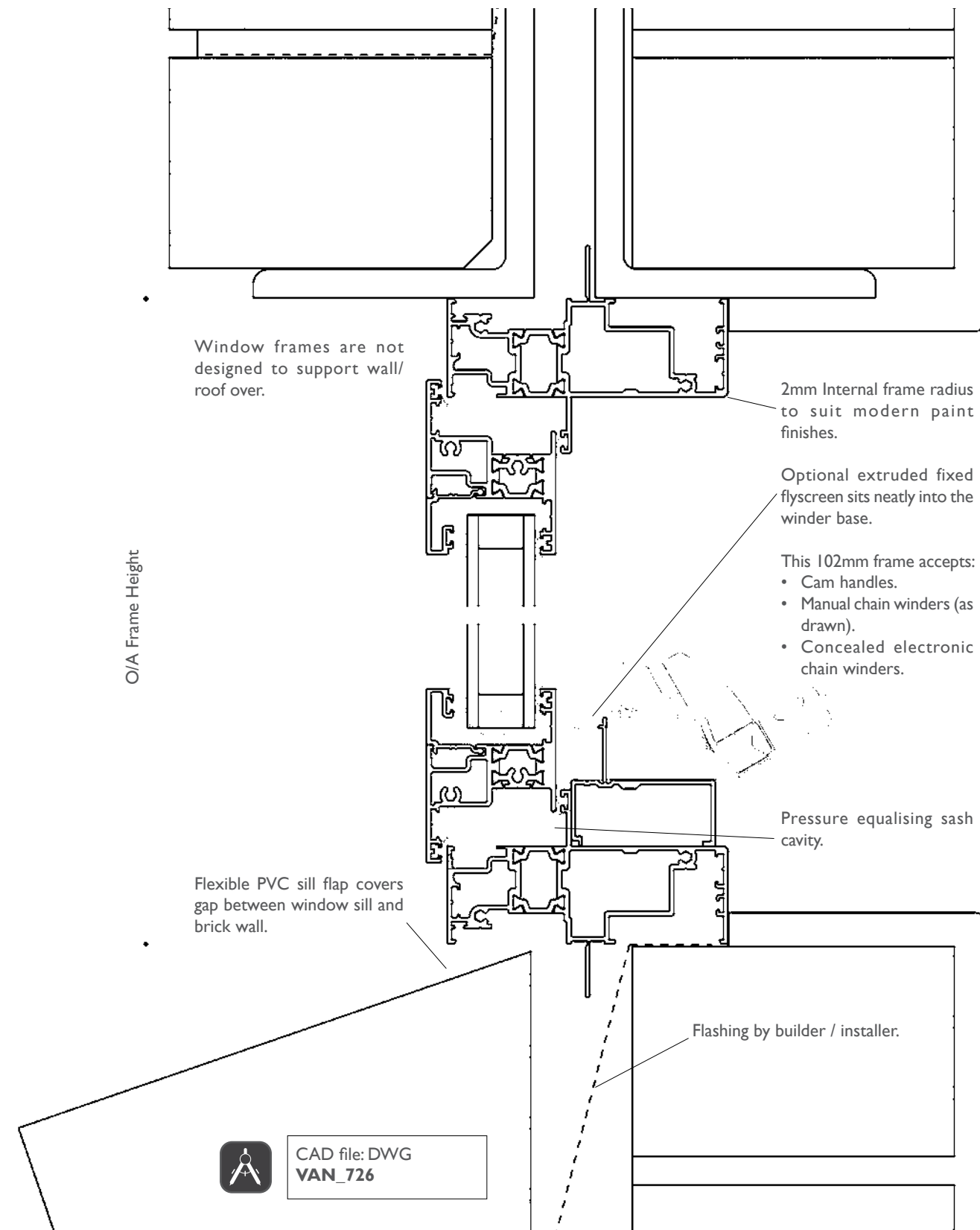

© Architectural Window Systems Pty Ltd 2021

Series 726 Thermally Broken Awning Window

DATE: NOV 09
REPLACES:
SCALE: NOT TO SCALE

HORIZONTAL CROSS SECTION INTO CAVITY BRICK WALL

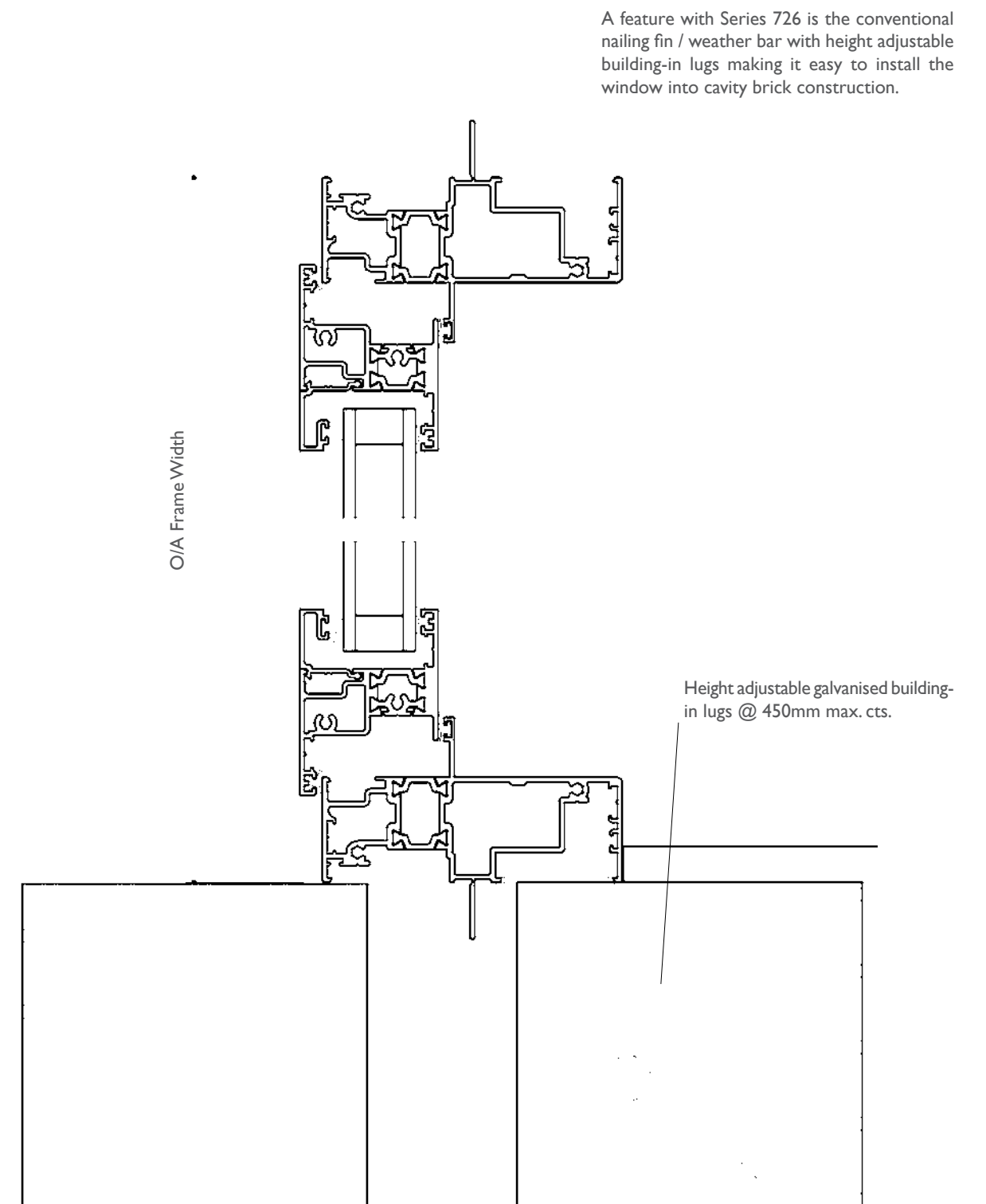

© Architectural Window Systems Pty Ltd 2021

Series 726 Thermally Broken Awning Window

DATE: NOV 09
REPLACES:
SCALE: NOT TO SCALE

FRAME TO MULLION TO TRANSOM JUNCTIONS

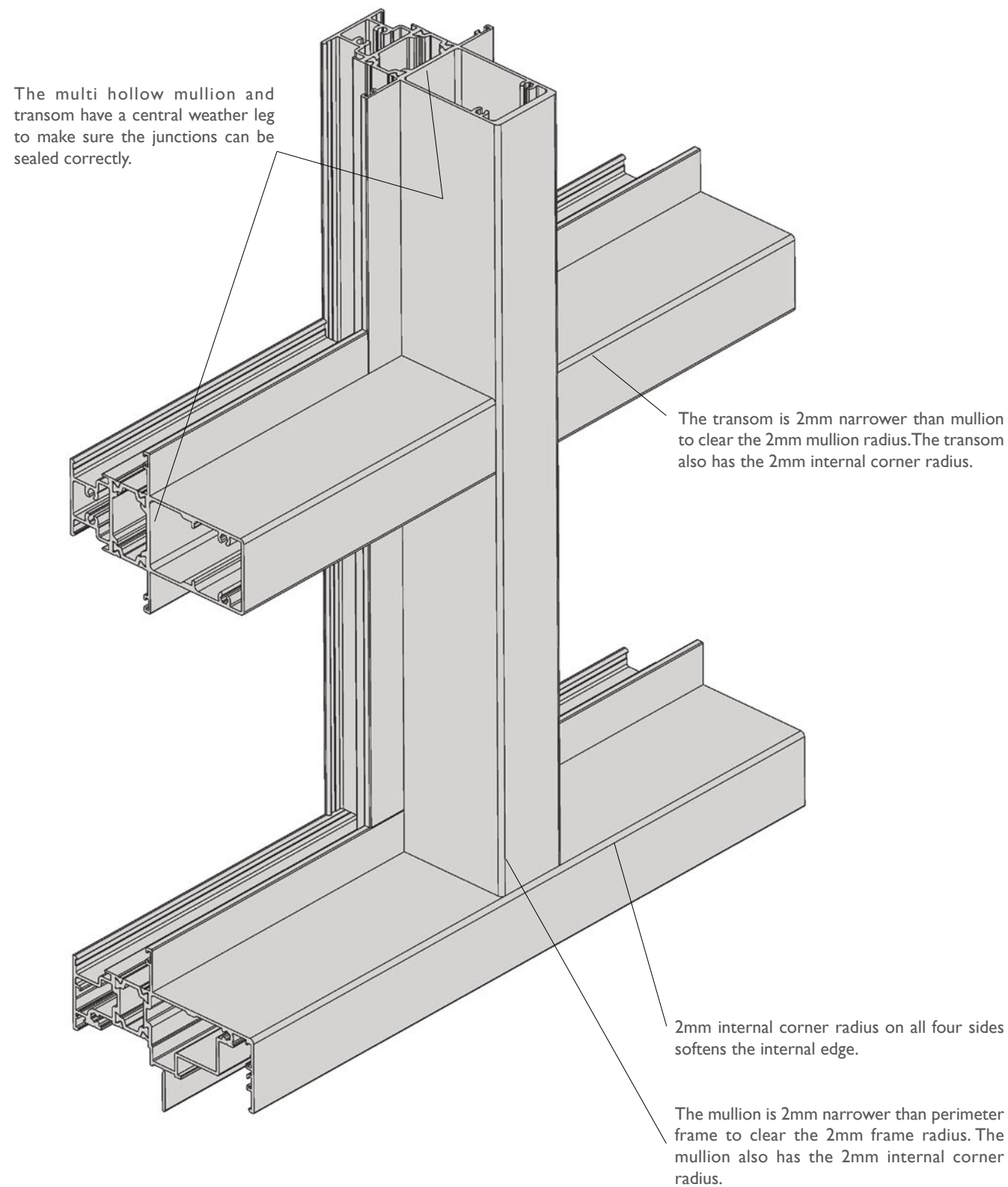

© Architectural Window Systems Pty Ltd 2021

Series 726 Thermally Broken Awning Window

DATE: NOV 09
REPLACES:
SCALE: HALF FULL SIZE

MULLION STRENGTH

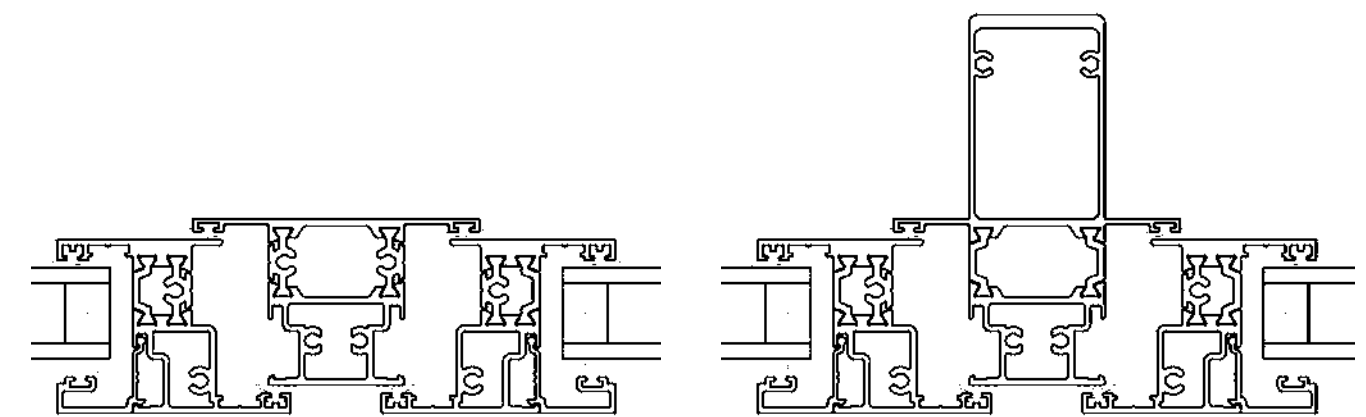

Light Mullion 72205

Note: This mullion is not suitable on windows fitted with chain winders.

Medium Mullion 72206

Medium Mullion 72206

Wind Ratings (Pa)

Frame Sizes		Ratings		
O/A Height mm	Mullion Cts. mm	Serviceability I/150	Serviceability I/180	Ultimate
1300	800	1844 Pa	1844 Pa	2766 Pa
1300	900	1714 Pa	1714 Pa	2571 Pa
1300	1000	1625 Pa	1625 Pa	2438 Pa
1300	1100	1571 Pa	1571 Pa	2356 Pa
1300	1200	1547 Pa	1547 Pa	2320 Pa
1400	800	1546 Pa	1546 Pa	2311 Pa
1400	900	1421 Pa	1421 Pa	2131 Pa
1400	1000	1335 Pa	1335 Pa	2003 Pa
1400	1100	1276 Pa	1276 Pa	1914 Pa
1400	1200	1239 Pa	1239 Pa	1859 Pa
1500	800	1308 Pa	1250 Pa	1962 Pa
1500	900	1200 Pa	1152 Pa	1800 Pa
1500	1000	1120 Pa	1080 Pa	1680 Pa
1500	1100	1062 Pa	1028 Pa	1592 Pa
1500	1200	1021 Pa	992 Pa	1531 Pa

© Architectural Window Systems Pty Ltd 2021

Series 726 Thermally Broken Awning Window

DATE: NOV 09
REPLACES:
SCALE: HALF FULL SIZE

HIGHLIGHT COUPLERS

Highlight Couplers

We have thermally broken couplers that will join awning frame to hinged, bi-fold or sliding doors as shown below.

Typical strength examples:

With an awning frame 600mm high over a door 2400mm high by 3600mm wide Standard coupler 72240 would rate 1618Pa Serviceability (1/150) 2688Pa Ultimate. Heavy coupler 72241 would rate 2529Pa Serviceability (1/150) 4688Pa Ultimate. Extra Heavy coupler 72242 would rate 3333Pa Serviceability (1/150) 5000Pa Ultimate.

From this you can see that the standard coupler would suit most projects and the heavy coupler would get used on wider bi-fold or sliding doors.

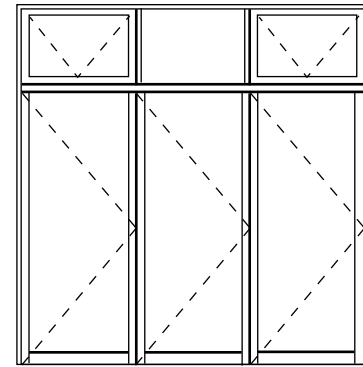

Awning highlight

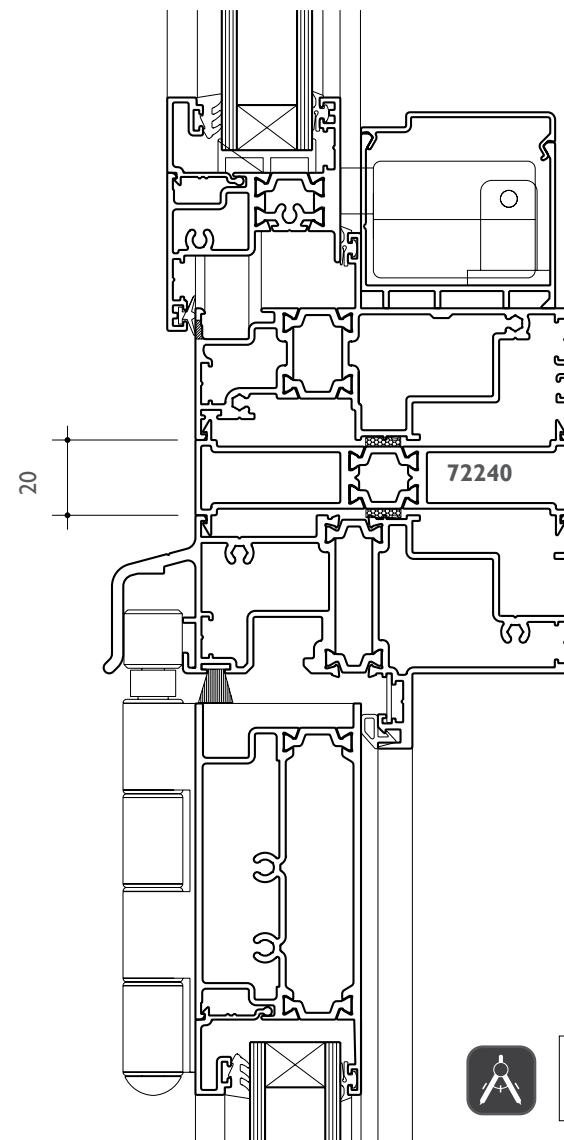

O/A Frame Width mm	Door Lowlight mm	Window Highlight mm	Service 1/150	Service 1/180	Ultimate
2400	2100	600	3333	3333	5000
2700	2100	600	3333	3333	5000
3000	2100	600	2899	2620	4348
3300	2100	600	2295	1913	3502
3600	2100	600	1730	1442	2888
3900	2100	600	1339	1115	2425
4200	2100	600	1058	881	2067
2400	2400	600	3333	3333	5000
2700	2400	600	3333	3333	5000
3000	2400	600	2746	2494	4118
3300	2400	600	2162	1802	3284
3600	2400	600	1618	1348	2688
3900	2400	600	1244	1037	2245
4200	2400	600	979	815	1905
2400	2700	600	3333	3333	5000
2700	2700	600	3333	3333	5000
3000	2700	600	2657	2422	3985
3300	2700	600	2075	1729	3137
3600	2700	600	1538	1281	2544
3900	2700	600	1174	979	2110
4200	2700	600	919	766	1782



CAD file: DWG or DXF
VAN_726

© Architectural Window Systems Pty Ltd 2021

Series 726 Thermally Broken Awning Window

DATE: NOV 09
REPLACES:
SCALE: HALF FULL SIZE

HIGHLIGHT COUPLERS

O/A Frame Width mm	Door Lowlight mm	Window Highlight mm	Service 1/150	Service 1/180	Ultimate
3600	2400	600	2529	2108	4688
3900	2400	600	1945	1621	3619
4200	2400	600	1530	1275	3324
4500	2400	600	1226	1022	2860
4800	2400	600	999	832	2488
3600	2700	600	2404	2003	4437
3900	2700	600	1836	1530	3681
4200	2700	600	1436	1197	3109
4500	2700	600	1146	955	2664
4800	2700	600	930	775	2310

Wind Ratings (Pa) 72241

O/A Frame Width mm	Door Lowlight mm	Window Highlight mm	Service 1/150	Service 1/180	Ultimate
4500	2400	600	2085	1737	3379
4800	2400	600	1698	1415	2940
5100	2400	600	1402	1169	2583
5400	2400	600	1172	977	2288
5700	2400	600	990	825	2042
4500	2700	600	1949	1624	3147
4800	2700	600	1582	1318	2730
5100	2700	600	1302	1085	2392
5400	2700	600	1086	905	2114
5700	2700	600	915	763	1883

Wind Ratings (Pa) 72242

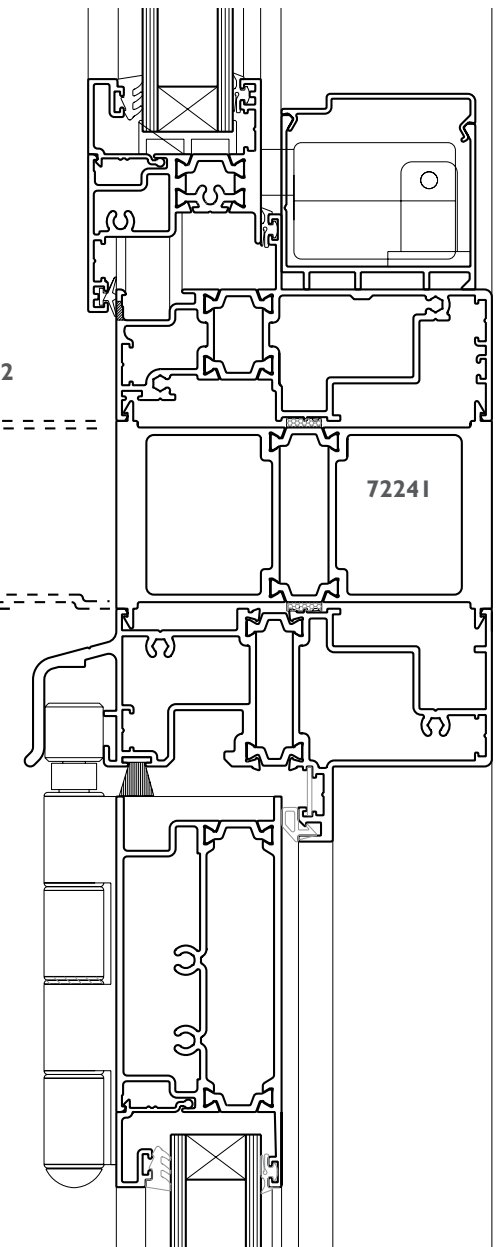
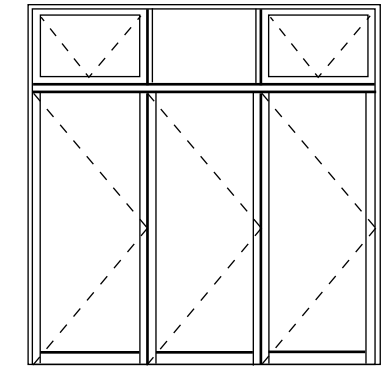

© Architectural Window Systems Pty Ltd 2021

Series 726 Thermally Broken Awning Window

DATE: APR 21
REPLACES: NOV 09
SCALE: NOT TO SCALE

HARDWARE MAKES THE DIFFERENCE

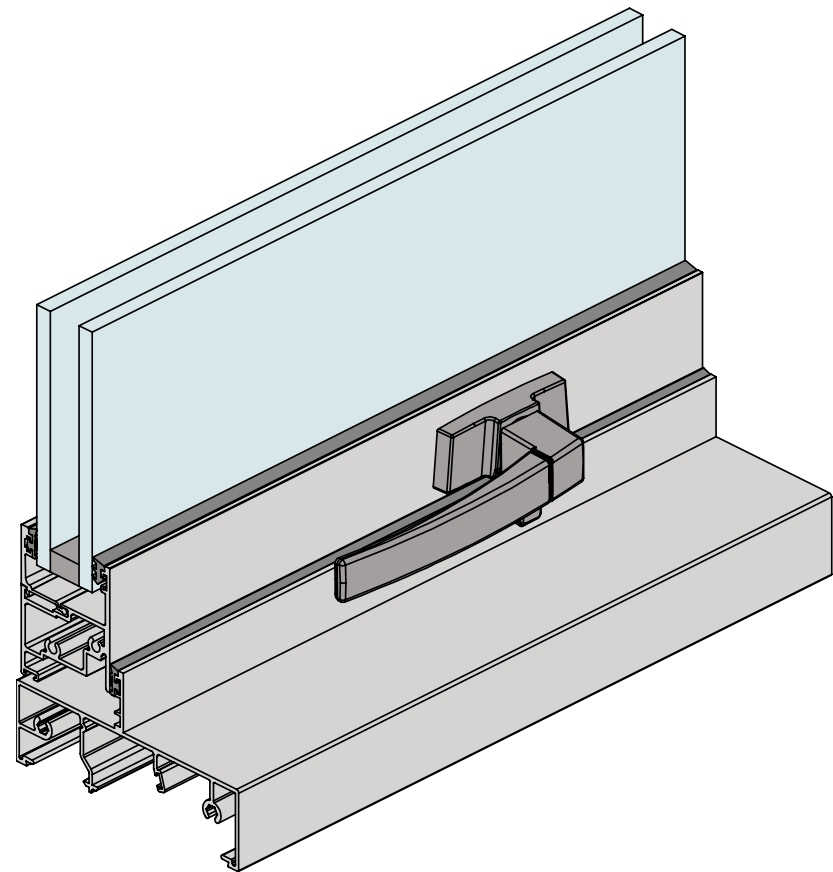

Manual Cam Handles

Fitted to awnings and casements that won't be fitted with flyscreens.

Main Features:

- Wedgeless - The keeper folds up as the cam is rotated up, staying with the cam handle as the sash is opened. This feature removes the keeper fixings from the frame upstand. These fixings can damage sash to frame seal.
- Concealed cam to sash fixings.
- The ICON™ Helix cam handle (shown above) only available in 316 stainless steel finish.

© Architectural Window Systems Pty Ltd 2021

Series 726 Thermally Broken Awning Window

DATE: NOV 09
REPLACES:
SCALE: HALF FULL SIZE

HARDWARE MAKES THE DIFFERENCE

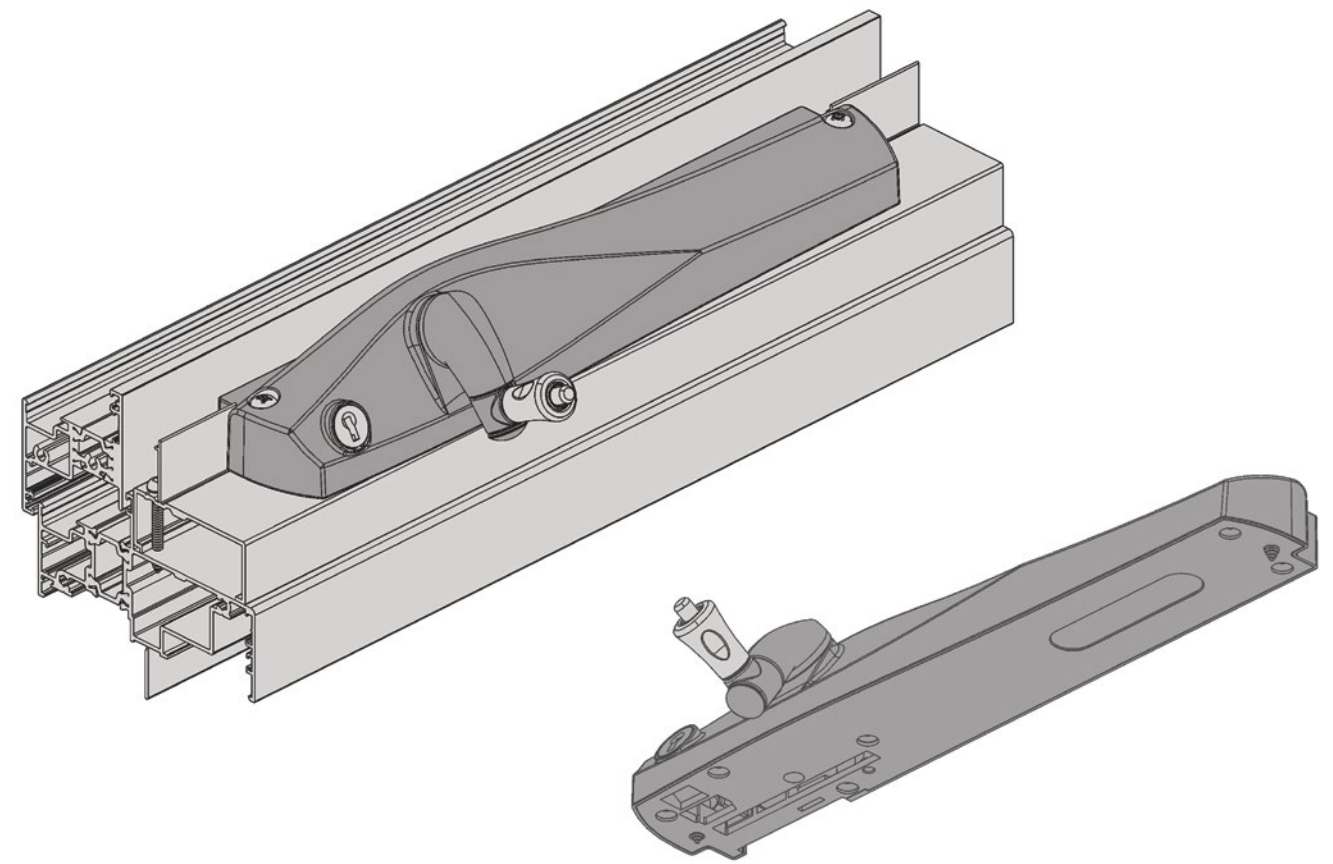

Manual Chain Winder

Fitting winders to awning windows make them easier to open and close when flyscreens are fitted.

Main Features:

- Corrosion resistant 304 stainless steel chains are standard.
- High quality engineered corrosion resistant Polesium™ base protects both winder and window sill from galvanic corrosion.
- Ten (10) year manufactures warranty.
- Designed to carry heavy sashes.
- Key locking standard on Vantage winders.
- Can be keyed to match other Vantage key lock windows.
- Screw fixing points can be subjected to excessive negative wind load when sashes are open. To resist this load we have thickened up the frame and sash at the fixing points.
- Besides the standard colour range we can offer these winders in an extensive range of special colours.

© Architectural Window Systems Pty Ltd 2021

Series 726

Thermally Broken Awning Window

DATE: NOV 09

REPLACES:

SCALE: NOT TO SCALE

HARDWARE MAKES THE DIFFERENCE

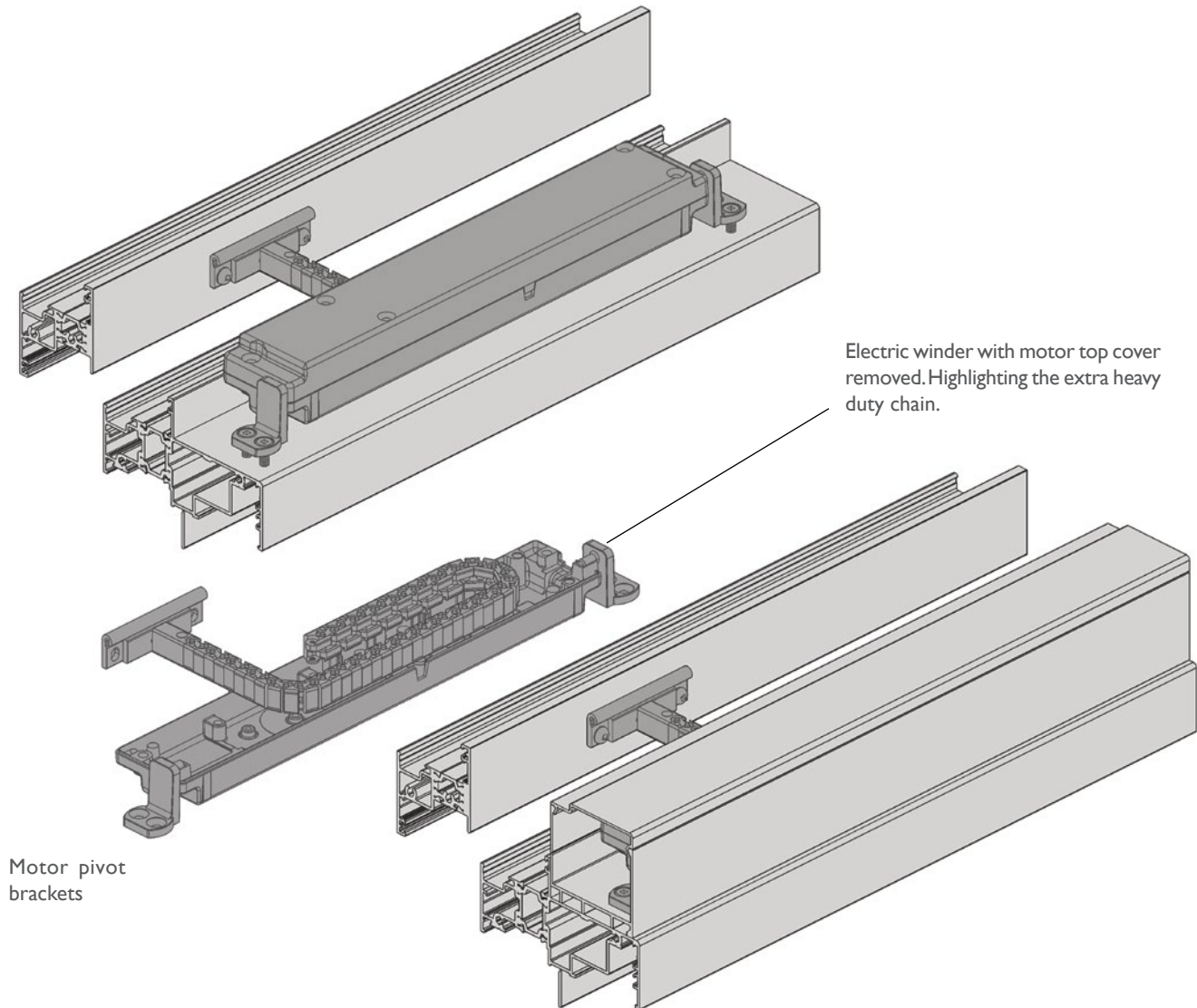
**Concealed Electric Chain Winder**

Fitting winders to awning windows make them easier to open and close when flyscreens are fitted.

Main Features:

- These electric winders are ideal for elevated sashes where access to cam handles or manual winder would be difficult/dangerous.
- Push button control or multi control touch pad available.
- Custom extruded aluminium box contains and conceals the winder body.
- Snap-on cover has front recess to accept optional flyscreen. This cover can be removed to allow access to the winder body for possible future maintenance.
- Extra heavy duty chrome plated chain. The chain is that strong the winder body has to pivot as the sash moves through the opening arc.
- Sashes with electric winder can be fitted with optional rain sensor that will close sash automatically when it rains and water intrusion is detected.
- Seven (7) year manufactures warranty.